

# LA ESCANDELLA

*technical manual*





# CONTENTS

---

04	<i>Fixing Requirements for Tiles &amp; Accessories</i>
06	<i>Rafter Lengths and Pitches</i>
08	<b><i>Product Range</i></b>
08	- <i>Curvado Profile</i>
12	- <i>Curvado Glazed Profile</i>
16	- <i>Marseille Profile</i>
20	- <i>Planum Profile</i>
24	- <i>Visum3 Profile</i>
28	- <i>Innova Profile</i>
32	- <i>Vienna Profile</i>
36	- <i>Medio Curva</i>
40	<i>Clay Barge Tile</i>
43	<i>Warranties</i>
45	<i>We Are Brickworks</i>
46	<i>Contact</i>

---

*Cover Image:* Planum Turrón

*Left:* Planum Blackstone

# FIXING REQUIREMENTS FOR TILES & ACCESSORIES

**TABLE 1**  
**AS 2050 Wind Classification and Maximum Design Gust Wind Speed**

Wind Classification	Maximum Design Gust Wind Speed (m/s)	
	Serviceability Limit State (Vs)	Ultimate Limit State (Vu)
N1	26	34
N2	26	40
N3C1	32	50
N4C2	39	61
C3	47	74

**Note:** Wind classifications in Table 1 are as defined in AS 4055

**TABLE 2**  
**Minimum Mechanical Installation Requirements for Tiles and Ancillaries**  
**TILES AND ANCILLARIES**

Wind Classification	Tile Installation		Ancillary Wind Installation (See Figures 1 & 2)
	Edge Of Roof	Field Of Roof	Ridge, Hip And Barge Tiles
N1 and N2	Mechanically fasten each full tile in second course and then every second tile in every course or every tile in each alternate course.		Mechanically fasten every tile
N3	Mechanically fasten each full tile in second course	Mechanically fasten each second full tile in every course	Mechanically fasten every tile
N4	Mechanically fasten each full tile	Mechanically fasten every full tile	Mechanically fasten every tile
C1	Mechanically fasten every full tile	Mechanically fasten each second full tile in every course	Mechanically fasten every tile
C2/C3	Mechanically fasten every full tile	Mechanically fasten every full tile	Mechanically fasten every tile

**Notes:**

**1.** Laboratory testing has shown that only a minor deflection of truly adherent mortar will result in a breakage of either, or both, ridge or tile upon deflection of the roof. In most instances of mortar bedding and pointing, a truly long-term adherent bond does not exist. Experience has shown that roofs in practice deflect and mortar does inevitably break. Therefore, mortar bonding should not be used as a minimum mechanical installation. **2.** For pitches over 35°, extra precautions shall be taken. Refer to tile manufacturer for technical recommendations. **3.** For values greater than C3, refer to manufacturer's recommendations. **4.** All tiles fixed in C2 or C3 rated sites must not use flexible pointing material, even where labelled as a mechanical fixing product, as the sole means of fixing ridge and hip tiles. All such tiles must now be fixed with an approved clip or screw, or such other method as advised by your tile manufacturer.



## FIXING REQUIREMENTS FOR TILES & ACCESSORIES

Bristle Roofing ceramic roof tiles are manufactured and tested to cope with a varied range of weather conditions.

Factors that can affect the design of your roof include:

### SELECTING THE ROOF TILE

The water courses formed in the body of a shaped/profiled roof tile prevent water from entering the side lap weather channel. Flat roof tiles that do not feature water courses have greater potential to experience side lap weather channel inundation. The shape of a tile should be considered carefully, particularly on roofs that are built in exposed areas where high winds and rainfall are common.

### THE PITCH OF THE ROOF

The pitch of the roof affects the speed of water flow down the roof plane. The greater the pitch, the faster the water will drain, conversely roofs with less pitch will drain more slowly and water depth, particularly towards the bottom of the roof, may be increased.

Tiling is not recommended for a roof pitch below 15 degrees without special safeguards being put in place. AS 2050 states where it is intended to fix tiles to roofs with a pitch of less than 15 degrees, the tile manufacturer's advice should be adhered to.

Sarking is a pliable foil installed prior to fixing the roof battens. Sarking acts as insulation keeping your home cool and free from dust as well as acting as a secondary water catchment. Your Bristle Roofing representative should be consulted when choosing the correct grade of sarking for your roof design. Table 3 (below) identifies the minimum roof pitch at which Bristle Roofing tiles are to be installed, showing each region with and without the need for sarking.

<b>TABLE 3</b> <b>Minimum Pitches for Fixing La Escandella Ranges</b>		
<b>La Escandella Roof Tile</b>	<b>Minimum Without Sark</b>	<b>Minimum With Sark</b>
Curvado/Curvado Glazed	20°	15°
Planum	20°	15°
Marseille	20°	15°
Vienna	20°	15°
Visum3	n/a	25°*
Medio Curva	n/a	10°**
La Escandella Innova	20°	15°

\* Breathable membrane to be used regardless of pitch

\*\* Rigid Underlay used instead of sarking up to 27° degrees. 28°+ install on battens and sarked compulsory.

**Note:** Roofs with pitches of less than 20° with sarking installed require Anti Ponding Boards to be fitted.

---

## RAFTER LENGTHS AND PITCHES

---

The minimum roof pitch recommended can be influenced by the water run off depth. Extremely long runs accumulate water to a considerable depth at the bottom of the run, particularly at low pitches, and in heavy rainfall conditions.

It is for this reason that Bristle Roofing recommends that any roof with rafter lengths in excess of 4.5 metres should be built at a pitch greater than the minimum stated in Table 7 on page 5 of this manual. The specified pitch should increase by 2° for every additional metre of rafter length.

Informative Notes in AS 2050.2002 "Installation of Roof Tiles", state: "Long rafter lengths may require sarking to prevent inundation of the roof.

These lengths may vary according to the tile profile used, the pitch of the roof and the exposure. The manufacturer's specification should be consulted." Table 4 indicates the maximum rafter lengths after which sarking must be installed to the area of roof that exceeds the noted maximum length.

<b>TABLE 4</b> <b>Sarking Requirements in Relation to Pitch/Rafter Length</b>	
<b>Roof - Degrees of Pitch</b>	<b>Maximum Rafter Length Without Sarking (mm)</b>
$\geq 18 < 20$	4.5
$\geq 20 < 22$	5.5
$\geq 22$	6.0



---

## LA ESCANDELLA

---

### *Curvado*

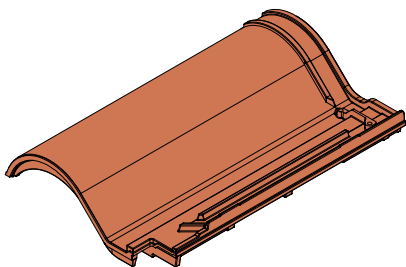

***The Curvado range captures a look of grandeur with a distinctively European style.***

A roof tile conceived to satisfy the needs and preferences of building professionals, the Curvado offers a variety of features which guarantee enduring popularity with home builders seeking a European style.

Manufactured from the highest quality clays, the Curvado incorporates a modern interlocking design which replicates



## LA ESCANDELLA

## Product Information

*Curvado Product Specifications*

Product Specification	
<b>Min Pitch:</b>	15 Degrees with Sarking, 20 Degrees without Sarking
<b>Optimum Set Out:</b>	400mm (+/- 5mm)
<b>First Batten:</b>	370mm (top of batten)
<b>Sarking:</b>	As noted in "Min Pitch" above
<b>Dimensions:</b>	470mm x 286mm x 75mm
<b>Weight:</b>	3.9kg
<b>Layed:</b>	Straight Bonded
<b>Tiles Per m2:</b>	11.40
<b>Weight per M²:</b>	44.46kg
<b>Cuts per LM:</b>	3
<b>Ridges per LM:</b>	2.5
<b>Batten per M²:</b>	2.9
<b>Batten:</b>	600 Centres - 40 x 25 HWD (QLD) / 38 x 38 Pine (NSW, ACT, VIC, SA, TAS) 38 x 25 Karri (WA) 900 Centres - 50 x 38 HWD (QLD, NSW, ACT, VIC, SA, TAS)
<b>Fixing:</b>	Head Lap Clip or Nailed
<b>Pallet Quantity:</b>	240 / 180

*Curvado Fittings*

Ridges	Apex	End Cap	Double Roll	Barges	Extras
					
Q02 Round Ridge	Q44 Round 3 Way Apex Ridge	Q83 Round Hip End Ridge Cap	Q33 Double Large Roof Tile (One per course on the left side) only)	Q12 Round LHS Course	Q10 Straight LHS Course
					
Q04 Round Hip End Ridge	Q45 Round 4 Way Apex Ridge			Q13 Round RHS Course	Q11 Straight LHS Course

## LA ESCANDELLA / CURVADO

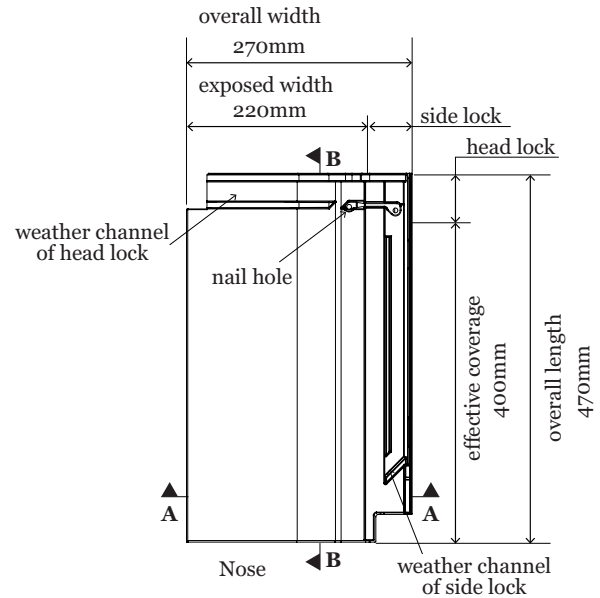
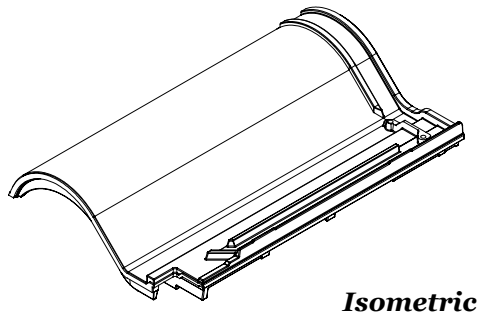
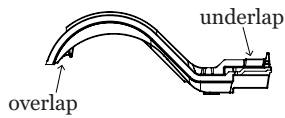
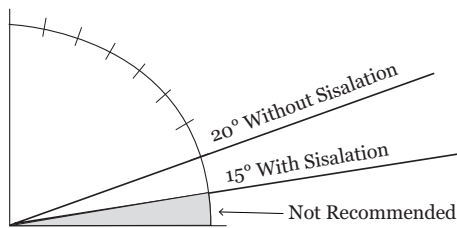
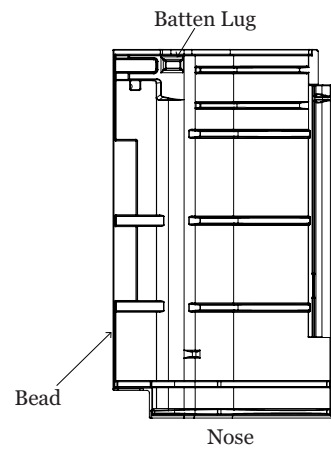
**Curvado Product  
& Test Specification****Face Side****Section A****Section B****Roof Pitch****Underside**

Testing Standard	Test Description	Std Tolerance	Average Curvado Result
AS - 4046.1	Distortion & Warpage	< 8mm	All Curvado tiles either comply or exceed the standard tolerances listed in this table.
AS - 4046.2	Batten lugs & Squareness	< 1.5% Length	
EN - 538	Transverse Strength	3 Nt/exposed mm of width	
EN - 539-2	Water Absorption	<10%	
EN - 539-1	Permeability	Two hour test	
EN - 539-1&2	Freeze / Thaw	150 cycles	
AS - 4046.7	Resistance to Salt Attack	Exposure	
AS - 4046.8	Dynamic weather resistance	Calibrated Datum	

LA ESCANDELLA / CURVADO

Curvado Product Identification  
& Layout Coursing Information

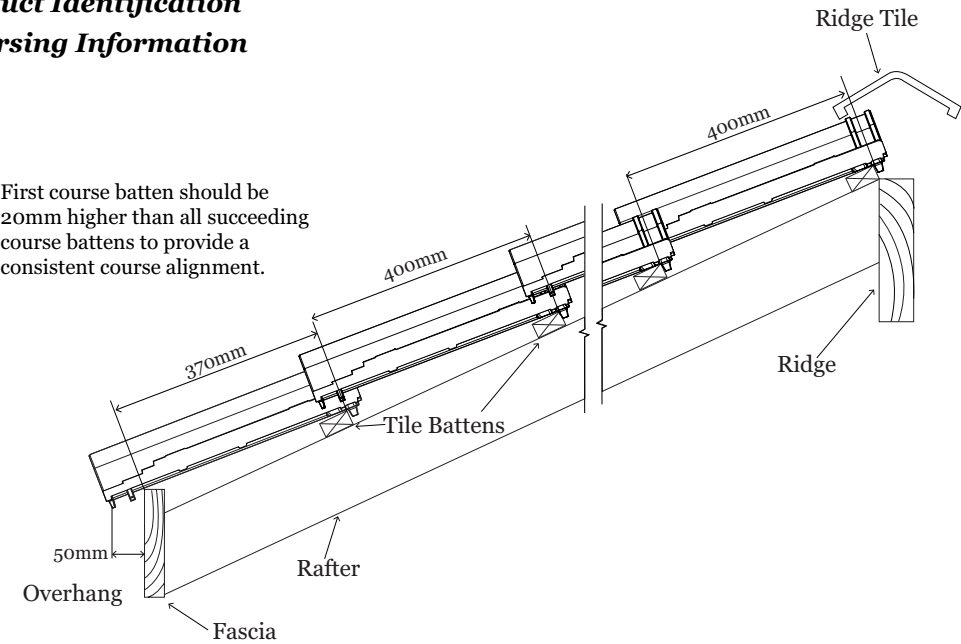

Section - Along Rafter

Curvado half tile roof laying

- Curvado roof tile
- Q12 round LHS course
- Q13 round RHS course
- Half tile (cut on site)

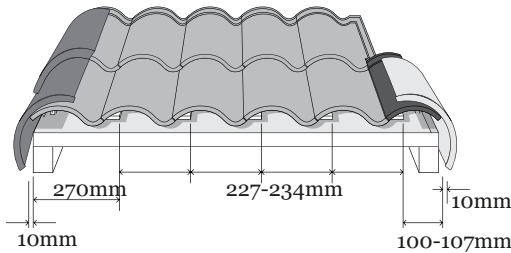

Curvado double roll roof tile laying

- Curvado roof tile
- Q10 straight LHS course
- Q33 double roll tile
- Q11 straight RSH course

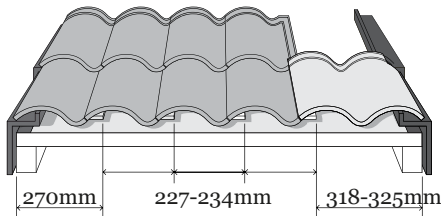

Section - Through Rafter

---

LA ESCANDELLA

---

## *Curvado Glazed*

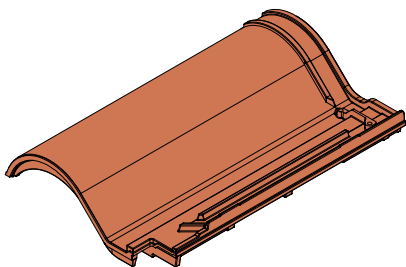

***For a bold, eye catching tile in colours designed to reflect your character, Bristile Roofing offers the Curvado Glazed range.***

A roof tile conceived to satisfy the needs and preferences of building professionals, the Curvado Glazed tile is available in two sizes and has a variety of features which guarantee enduring popularity with home builders seeking a European style. Manufactured from the highest quality clays, the Curvado Glazed incorporates a modern interlocking design which replicates the traditional pan and cover tile that has been a hallmark of European and Mediterranean architecture for centuries.













## LA ESCANDELLA

## Product Information

*Curvado Glazed Product Specifications*

Product Specification	
<b>Min Pitch:</b>	15 Degrees with Sarking, 20 Degrees without Sarking
<b>Optimum Set Out:</b>	400mm (+/- 5mm)
<b>First Batten:</b>	370mm (top of batten)
<b>Sarking:</b>	As noted in "Min Pitch" above
<b>Dimensions:</b>	470mm x 286mm x 75mm
<b>Weight:</b>	3.9kg
<b>Layed:</b>	Straight Bonded
<b>Tiles Per m<sup>2</sup>:</b>	11.40
<b>Weight per M<sup>2</sup>:</b>	44.46kg
<b>Cuts per LM:</b>	3
<b>Ridges per LM:</b>	2.5
<b>Batten per M<sup>2</sup>:</b>	2.9
<b>Batten:</b>	600 Centres - 40 x 25 HWD (QLD) / 38 x 38 Pine (NSW, ACT, VIC, SA, TAS) 38 x 25 Karri (WA) 900 Centres - 50 x 38 HWD (QLD, NSW, ACT, VIC, SA, TAS)
<b>Fixing:</b>	Head Lap Clip or Nailed
<b>Pallet Quantity:</b>	240 / 180

*Curvado Glazed Fittings*

Ridges	Apex	End Cap	Double Roll	Barges	Extras
					
Q02 Round Ridge	Q44 Round 3 Way Apex Ridge	Q83 Round Hip End Ridge Cap	Q33 Double Large Roof Tile (One per course on the left side) only)	Q12 Round LHS Course	Q10 Straight LHS Course
					
Q04 Round Hip End Ridge	Q45 Round 4 Way Apex Ridge			Q13 Round RHS Course	Q11 Straight LHS Course

## LA ESCANDELLA / CURVADO GLAZED

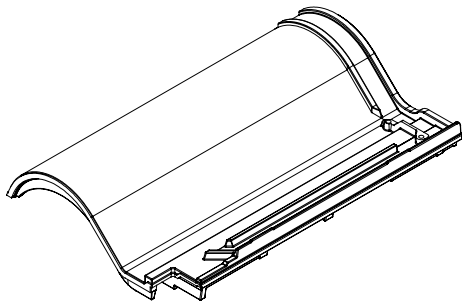
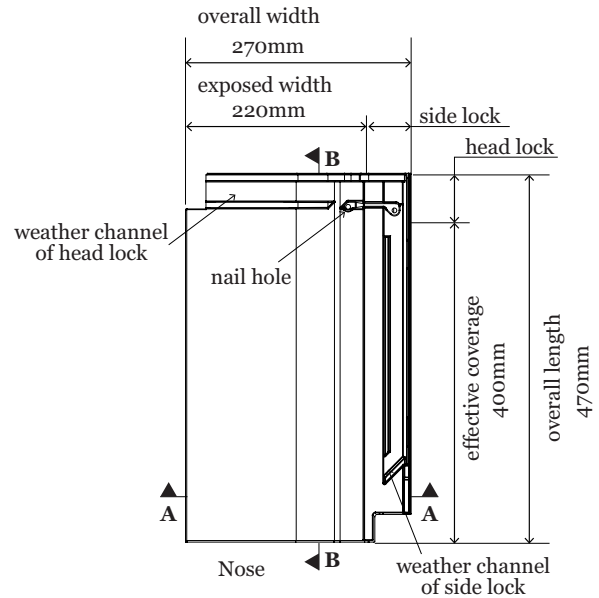
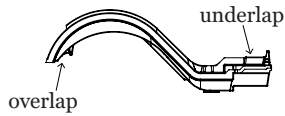
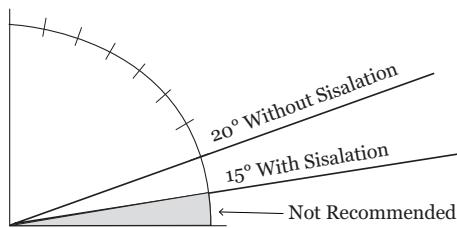
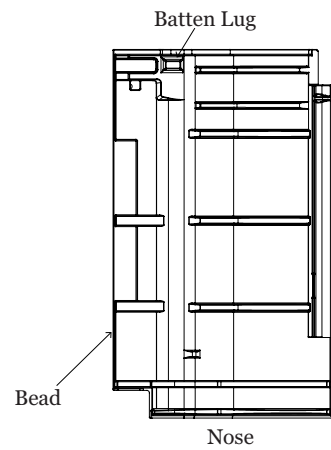
**Curvado Product  
& Test Specification****Isometric****Face Side****Section A****Section B****Roof Pitch****Underside**

Testing Standard	Test Description	Std Tolerance	Average Curvado Result
AS - 4046.1	Distortion & Warpage	< 8mm	All Curvado tiles either comply or exceed the standard tolerances listed in this table.
AS - 4046.2	Batten lugs & Squareness	< 1.5% Length	
EN - 538	Transverse Strength	3 Nt/exposed mm of width	
EN - 539-2	Water Absorption	<10%	
EN - 539-1	Permeability	Two hour test	
EN - 539-1&2	Freeze / Thaw	150 cycles	
AS - 4046.7	Resistance to Salt Attack	Exposure	
AS - 4046.8	Dynamic weather resistance	Calibrated Datum	

LA ESCANDELLA / CURVADO GLAZED

Curvado Product Identification  
& Layout Coursing Information

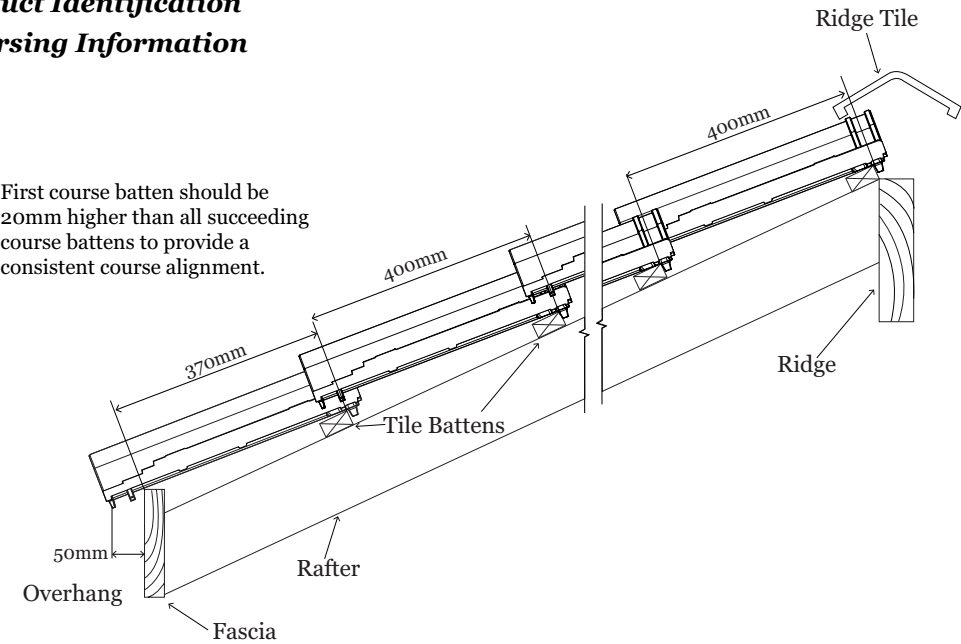

Section - Along Rafter

Curvado half tile roof laying

- Curvado roof tile
- Q12 round LHS course
- Q13 round RHS course
- Half tile (cut on site)

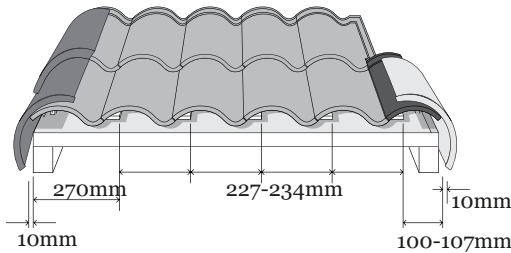

Curvado double roll roof tile laying

- Curvado roof tile
- Q10 straight LHS course
- Q33 double roll tile
- Q11 straight RSH course

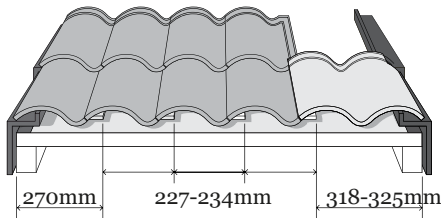

Section - Through Rafter

---

## LA ESCANDELLA

---

# *Marseille*

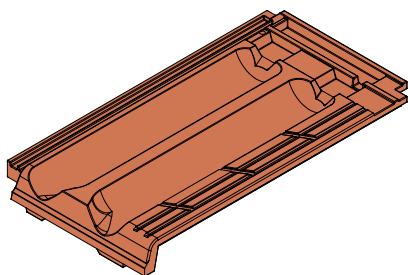

***Originating from France, the Marseille tile offers versatility and simplicity in a classic style clay roof tile.***

The Marseille tile continues the proud tradition of the tile maker's craft with a tile that suits a range of architectural styles.

The combination of its sharp clean lines and natural colour palette result in a roof tile with a timeless look and unmistakable style. Offering the colour longevity, strength, and durability of clay, the Marseille is ideal for homes of distinction.



## LA ESCANDELLA

## Product Information

*Marseille Product Specifications*

Product Specification	
<b>Min Pitch:</b>	15 Degrees with Sarking, 20 Degrees without Sarking
<b>Optimum Set Out:</b>	398mm (+/- 5mm)
<b>First Batten:</b>	370mm (top of batten)
<b>Sarking:</b>	As noted in "Min Pitch" above
<b>Dimensions:</b>	466mm x 260mm x 55mm
<b>Weight:</b>	3.6kg
<b>Layed:</b>	Cross Bonded
<b>Tiles Per M<sup>2</sup>:</b>	11.1
<b>Weight per M<sup>2</sup>:</b>	39.96kg
<b>Cuts per LM:</b>	3
<b>Ridges per LM:</b>	2.5
<b>Betten per M<sup>2</sup>:</b>	2.9
<b>Batten:</b>	600 Centres - 40 x 25 HWD (QLD) / 38 x 38 Pine (NSW, ACT, VIC, SA, TAS) / 38 x 25 Karri (WA) 900 Centres - 50 x 38 HWD (QLD, NSW, ACT, VIC, SA, TAS)
<b>Fixing:</b>	Head Lap Clip or Nailed
<b>Pallet Quantity:</b>	240/180

*Marsielle Fittings*

## Ridges



Q90 Collarless Ridge

## Apex

Q111 Collarless  
3 Way End Ridge

## Hip End

Q109 Collarless  
Hip End Ridge

## Double Roll

N/A

## Barges



Q91 Pyramid Ridge

## Extras



Q21 Ventilation Tile

## LA ESCANDELLA / MARSEILLE

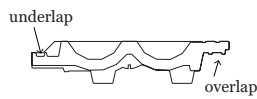
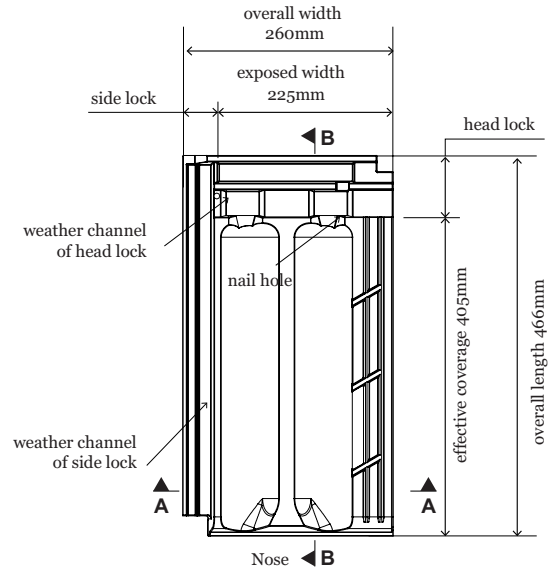
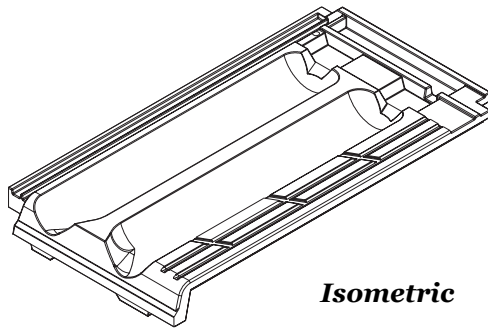
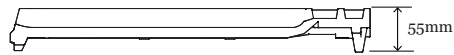
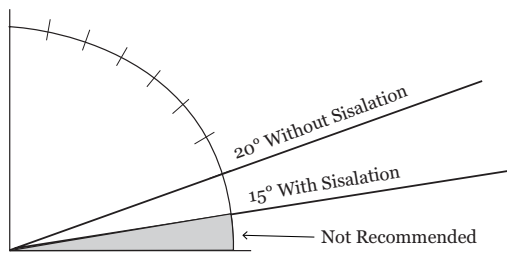
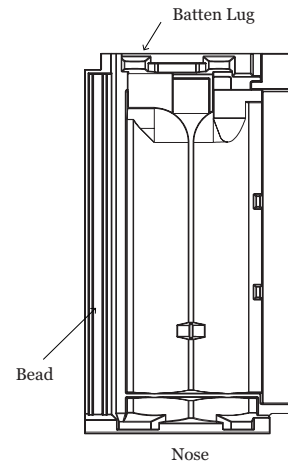
**Marseille Product  
& Test Specification****Section A****Section B****Roof Pitch****Underside**

Testing Standard	Test Description	Std Tolerance	Average Marseille Result
AS - 4046.1	Distortion & Warpage	< 8mm	All Marseille tiles either comply or exceed the standard tolerances listed in this table.
AS - 4046.2	Batten lugs & Squareness	< 1.5% Length	
EN - 538	Transverse Strength	3 Nt/exposed mm of width	
EN - 539-2	Water Absorption	<10%	
EN - 539-1	Permeability	Two hour test	
EN - 539-1&2	Freeze / Thaw	150 cycles	
AS - 4046.7	Resistance to Salt Attack	Exposure	
AS - 4046.8	Dynamic weather resistance	Calibrated Datum	

LA ESCANDELLA / MARSEILLE

Marseille Product Identification  
& Layout Coursing Information

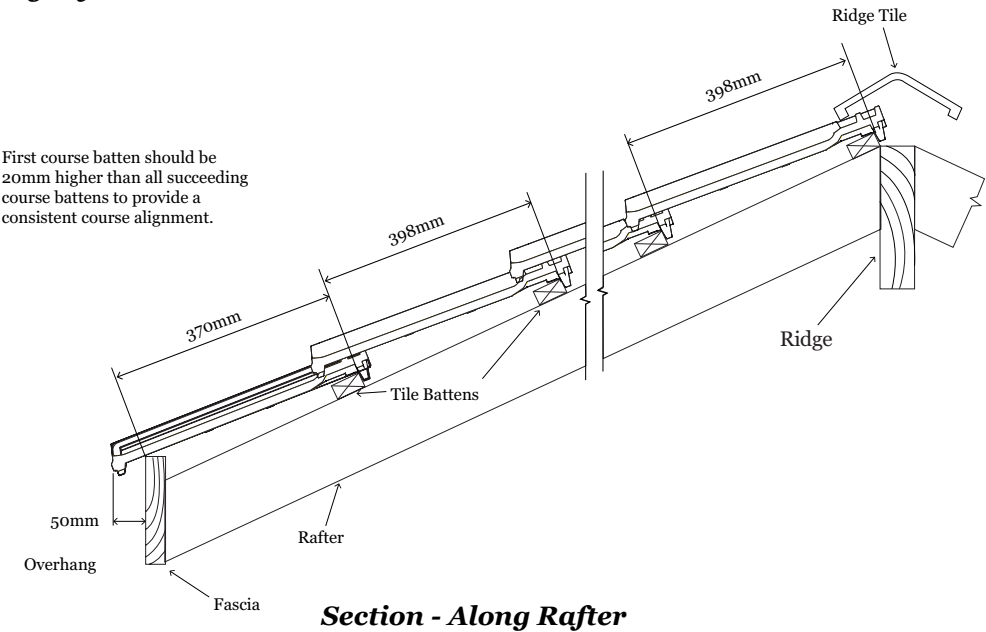

Marseille cross bonded  
roof tile laying

- Marseille Roof tile
- Q91 Pyramid Ridge
- Half tile (Cut on site)

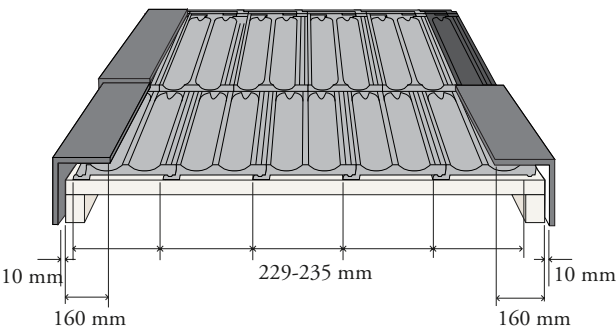

---

## LA ESCANDELLA

---

### *Planum*



***Aesthetics and functionality are brought together in the Planum range, a collection of tiles that combines a traditional roofing material with contemporary architectural style.***

Planum creates a look of simplicity and elegance with monotone colour options developed to complement the sleek, refined shape of the tile. Due to its innovative design and size, the Planum tile is faster and easier to install, lowering installation time and costs. Furthermore the highly weatherproof design means it can be applied to roof pitches as low as fifteen degrees.



## LA ESCANDELLA

## Product Information

*Planum Product Specifications*

Product Specification	
<b>Min Pitch:</b>	15 Degrees with Sarking, 20 degrees without Sarking
<b>Optimum Set Out:</b>	365mm (+5/-50mm) <i>Effective for stock dated after March 2019</i>
<b>First Batten:</b>	360mm (top of batten)
<b>Sarking:</b>	As noted in "Min Pitch" above
<b>Dimensions:</b>	440mm x 280mm x 32mm
<b>Weight:</b>	3.5kg
<b>Layed:</b>	Cross Bonded
<b>Tiles Per m2:</b>	11.7
<b>Weight per M²:</b>	38.5kg
<b>Cuts per LM:</b>	3.5
<b>Ridges per LM:</b>	2.5
<b>Batten per M²:</b>	3.2
<b>Batten:</b>	600 Centres - 40 x 25 HWD (QLD) / 38 x 38 Pine (NSW, ACT, VIC, SA, TAS) 38 x 25 Karri (WA) 900 Centres - 50 x 38 HWD (QLD, NSW, ACT, VIC, SA, TAS)
<b>Fixing:</b>	Head Lap Clip or Nailed
<b>Pallet Quantity:</b>	240 / 320

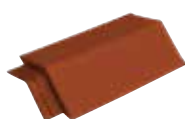
*Planum Fittings***Ridges**Q90 Collarless  
Ridge**Apex**Q111 Collarless 3  
Way Apex**Hip End**Q109 Collarless Hip  
End Ridge**Double Roll**

N/A

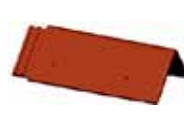
**Barges**

Q91 Pyramid Ridge

## LA ESCANDELLA / PLANUM

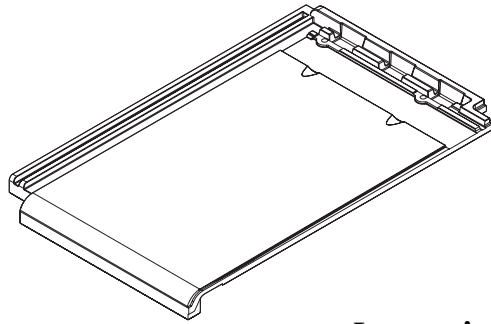
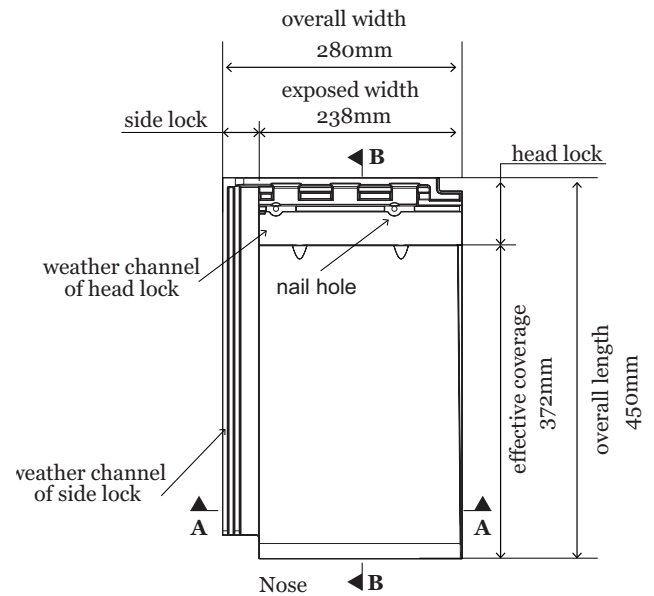
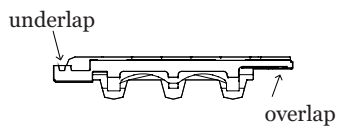
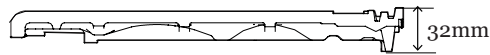
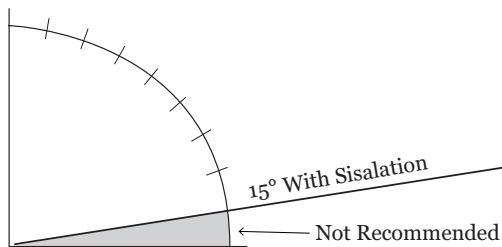
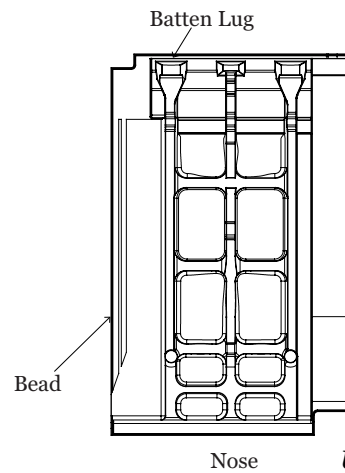
**Planum Product  
& Test Specification****Isometric****Face Side****Section A****Section B****Roof Pitch****Underside**

Testing Standard	Test Description	Std Tolerance	Average Planum Result
AS - 4046.1	Distortion & Warpage	< 8mm	All Planum tiles either comply or exceed the standard tolerances listed in this table.
AS - 4046.2	Batten lugs & Squareness	< 1.5% Length	
EN - 538	Transverse Strength	3 Nt/exposed mm of width	
EN - 539-2	Water Absorption	<10%	
EN - 539-1	Permeability	Two hour test	
EN - 539-1&2	Freeze / Thaw	150 cycles	
AS - 4046.7	Resistance to Salt Attack	Exposure	
AS - 4046.8	Dynamic weather resistance	Calibrated Datum	

LA ESCANDELLA / PLANUM

Planum Product Identification  
& Layout Coursing Information

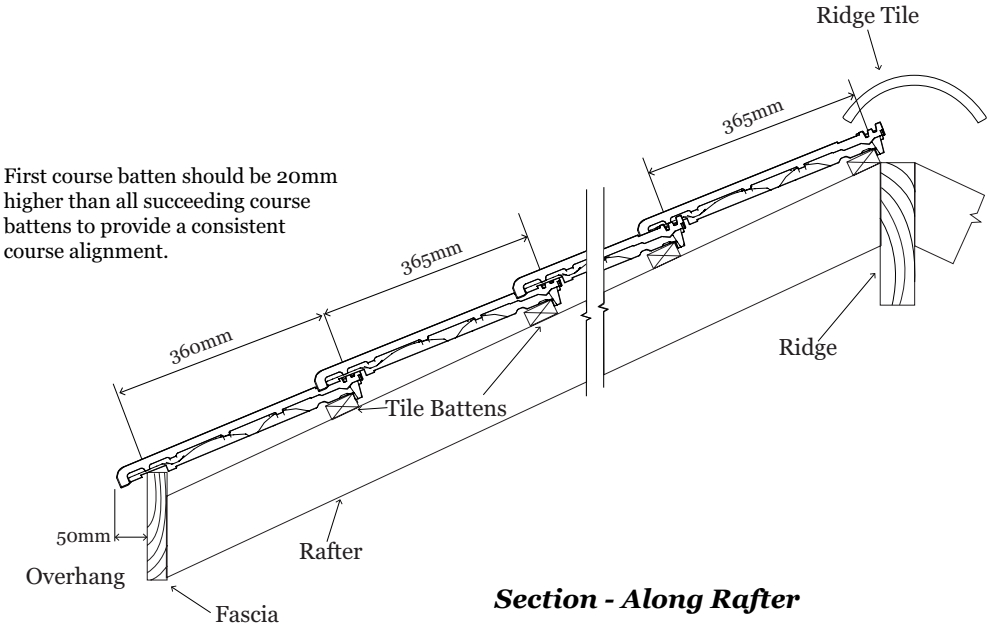

Planum cross bonded  
roof tile laying

- Marseille Roof tile
- Q91 Pyramid Ridge
- Half tile (Cut on site)

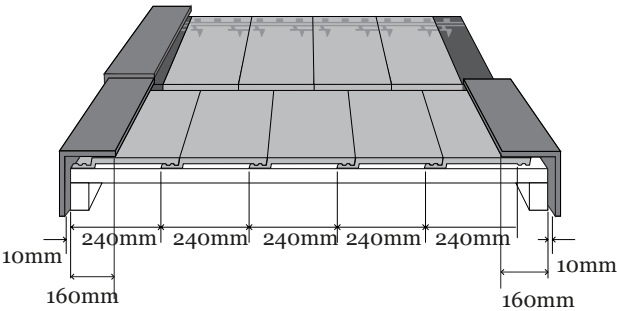

---

## LA ESCANDELLA

---

# *Visum3*

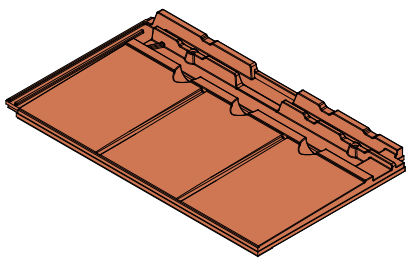

***A new era in roofing products has arrived  
with the Visum3 tile from Bristle Roofing.***

Featuring a truly revolutionary interlocking design, the Visum3 has been designed to replicate smaller slate and clay tiles without the associated costs. Introduced with a 20 year patent, the Visum3 provides an affordable alternative for those desiring a shingle roof. Industry leading technology enables each tile to be coloured individually with realistic pitting on the tiles surface for authenticity. Featuring a slim 9mm nose, the Visum3 achieves ultra flat laying for the ultimate shingle and slate appearance.





LA ESCANDELLA

Product Information

Visum3 Product Specifications

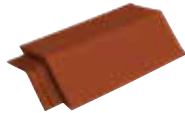
Product Specification	
Min Pitch:	25 Degrees with Breathable Membrane
Optimum Set Out:	187mm (+/- 5mm)
First Batten:	206mm (top of batten)
Sarking:	Mandatory (Breathable membrane to be used)
Dimensions:	280mm x 480mm x 35mm
Weight:	3.85kg
Layed:	Cross Bonded (watercourse high bead in line with central frog)
Tiles Per m2:	11.9
Weight per M²:	44.27kg
Cuts per LM:	8
Ridges per LM:	2.5
Batten per M²:	5.8
Batten:	600 Centres - 40 x 25 HWD (QLD) / 38 x 38 Pine (NSW, ACT, VIC, SA, TAS) 38 x 25 Karri (WA) 900 Centres - 50 x 38 HWD (QLD, NSW, ACT, VIC, SA, TAS)
Fixing:	Head Lap Clip or Nailed
Pallet Quantity:	280 / 210

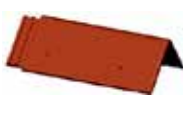
Visum3 Fittings

Ridges	Apex	Hip End	Double Roll	Barges	Extras
			N/A		
Q90 Collarless Ridge	Q111 Collarless 3 Way Apex	Q109 Collarless Hip End Ridge		Q91 Pyramid Ridge	Q96 Ventiation Tile

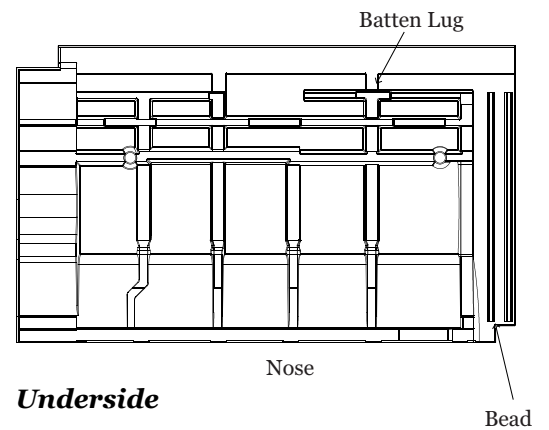
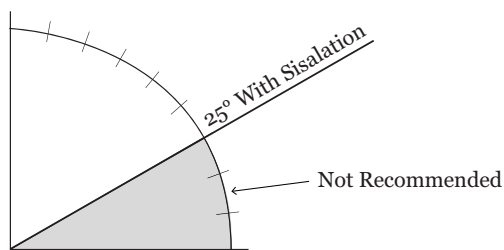
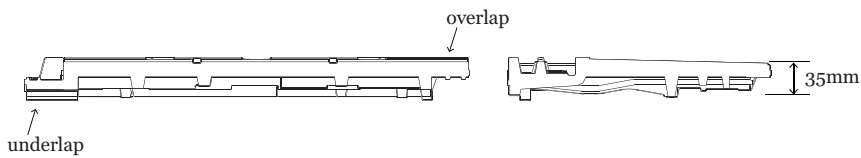
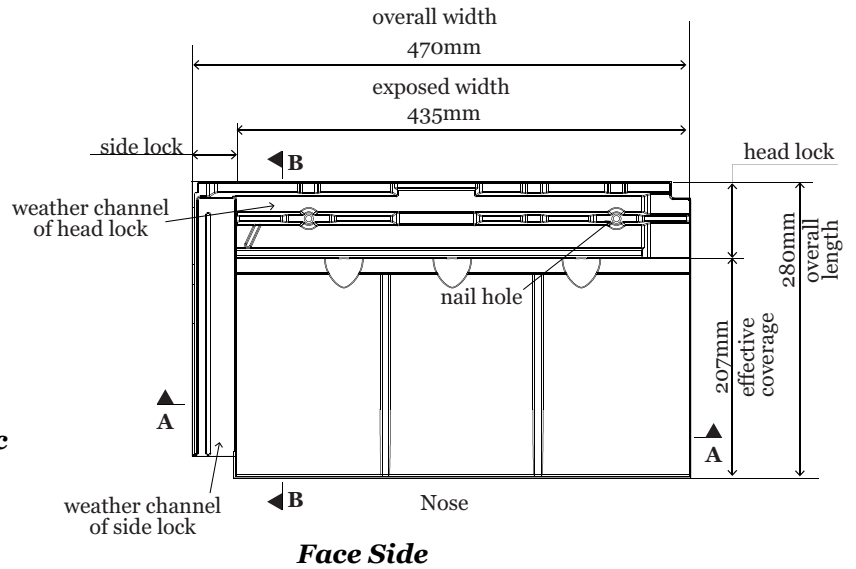
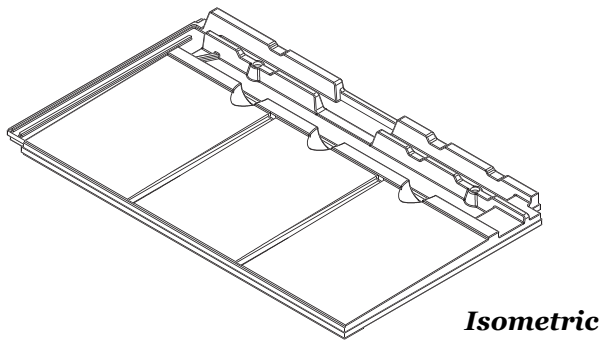

## LA ESCANDELLA / VISUM3

**Visum3 Product  
& Test Specification**

Testing Standard	Test Description	Std Tolerance	Average Visum3 Result
AS - 4046.1	Distortion & Warpage	< 8mm	All Visum3 tiles either comply or exceed the standard tolerances listed in this table.
AS - 4046.2	Batten lugs & Squareness	< 1.5% Length	
EN - 538	Transverse Strength	3 Nt/exposed mm of width	
EN - 539-2	Water Absorption	<10%	
EN - 539-1	Permeability	Two hour test	
EN - 539-1&2	Freeze / Thaw	150 cycles	
AS - 4046.7	Resistance to Salt Attack	Exposure	
AS - 4046.8	Dynamic weather resistance	Calibrated Datum	

# LA ESCANDELLA / VISUM3

## Visum3 Product Identification & Layout Coursing Information

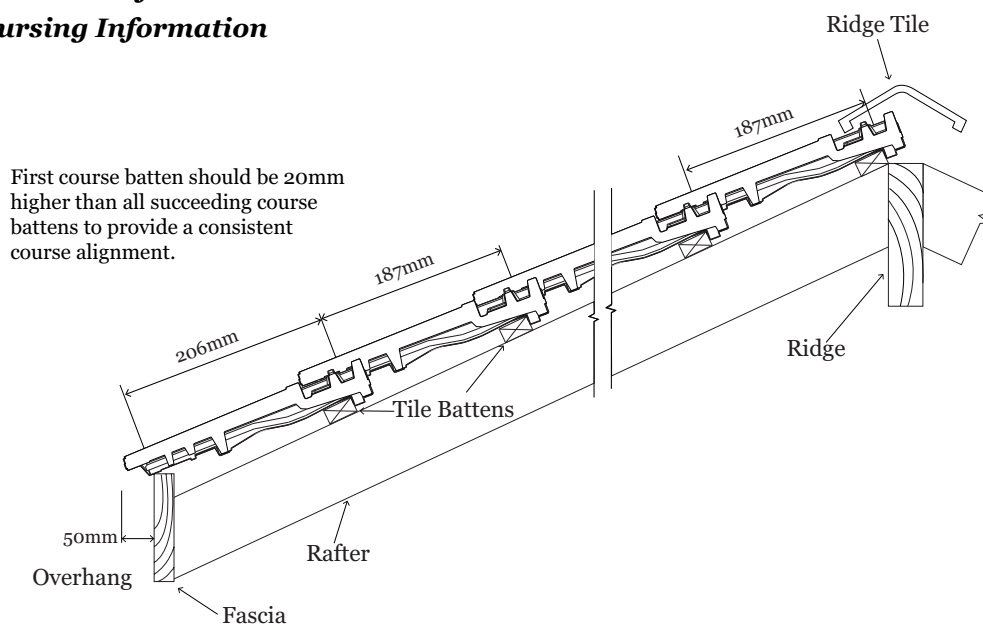

**Section - Along Rafter**

## Visum3 roof tile laying

- Visum3 roof tile
- Q91 Pyramid Ridge

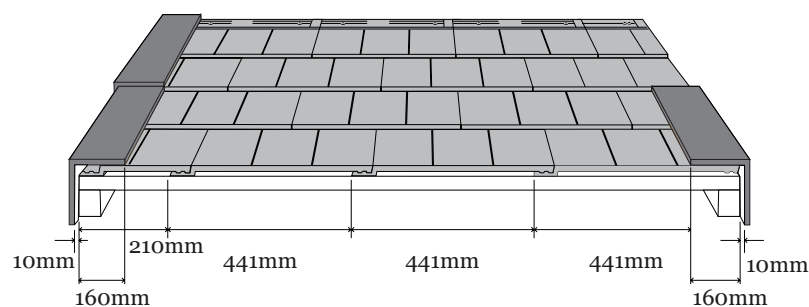

**Section - Through Rafter**

---

## LA ESCANDELLA

---

### *Innova*

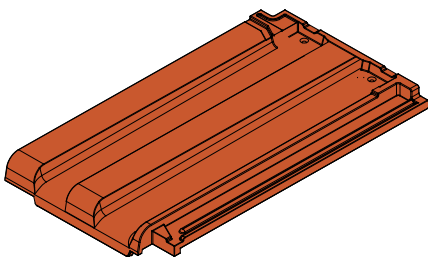

***Discover the latest innovation from  
La Escandella with the Innova range.***

The Innova is a shaped roof tile with a sleek refined finish. The combination of it's sharp clean lines and natural clay colour palette result in a roof tile with a timeless look and unmistakeable style. Offering the colour longevity, strength, and durability of clay, the Innova suits a range of house design.

LA ESCANDELLA

Product Information

Innova Product Specifications

Product Specification	
Min Pitch:	15 Degrees with Sarking, 20 Degrees without Sarking
Optimum Set Out:	390mm (+5mm/-70mm)
First Batten:	380mm (top of batten)
Sarking:	As noted in “Min Pitch” below
Dimensions:	4560mm x 255mm x 30mm
Weight:	3.4kg
Layed:	Straight or Cross Bonded
Tiles Per m2:	12.1
Weight per M²:	39.1kg (Tiles Only)
Cuts per LM:	3
Ridges per LM:	2.5
Battern per M²:	2.9
Batten:	600 Centres - 38 x 25 Karri (WA)
Fixing:	Head Lap Clip or Nailed
Pallet Quantity:	216/288

Innova Fittings

Ridges

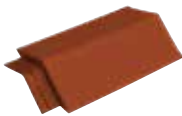

Q90 Collarless Ridge

Apex



Q111 Collarless 3 Way Apex

Hip End



Q109 Collarless Hip End Ridge

Double Roll

N/A

Barges

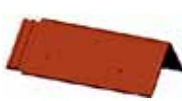

Q91 Pyramid Ridge

## LA ESCANDELLA / INNOVA

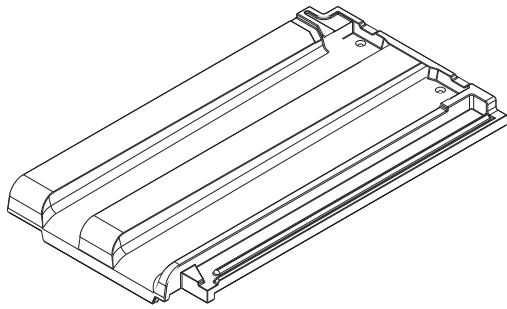
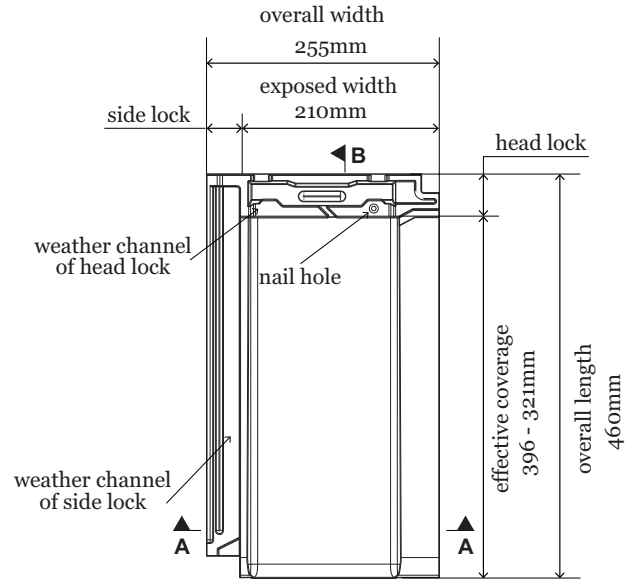
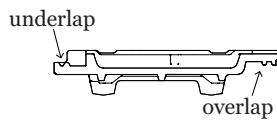
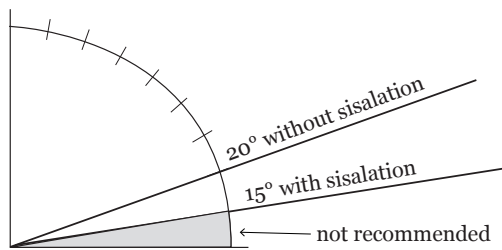
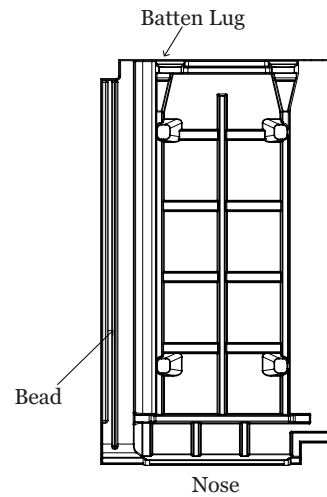
**Innova Product  
& Test Specification****Isometric****Face Side****Section A****Section B****Roof Pitch****Underside**

Testing Standard	Test Description	Std Tolerance	Average Innova Result
AS - 4046.1	Distortion & Warpage	< 8mm	All Innova tiles either comply or exceed the standard tolerances listed in this table.
AS - 4046.2	Batten lugs & Squareness	< 1.5% Length	
EN - 538	Transverse Strength	3 Nt/exposed mm of width	
EN - 539-2	Water Absorption	<10%	
EN - 539-1	Permeability	Two hour test	
EN - 539-1&2	Freeze / Thaw	150 cycles	
AS - 4046.7	Resistance to Salt Attack	Exposure	
AS - 4046.8	Dynamic weather resistance	Calibrated Datum	



# LA ESCANDELLA / INNOVA

## Innova Product Identification & Layout Coursing Information

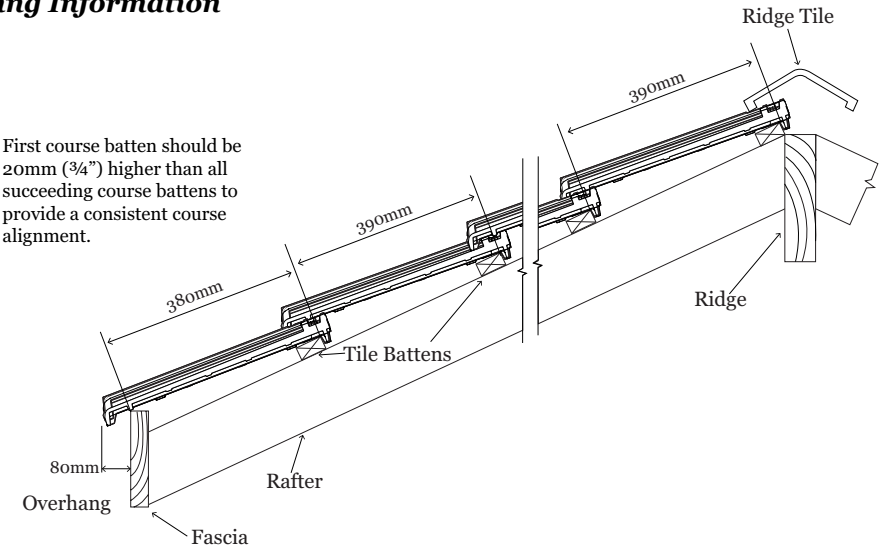

Section - Along Rafter

## Innova bond pattern / Continuous joints laying

- Innova roof tile
- Q91 Pyramid Ridge

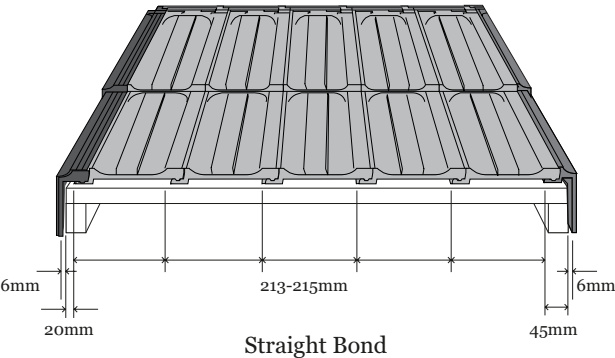

Section - Through Rafter

---

LA ESCANDELLA

---

## *Vienna*

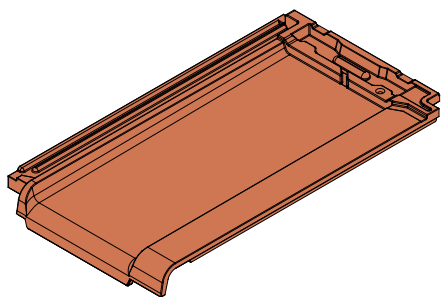

***With sharp lines and bold pastel colours  
the Vienna range is designed for  
contemporary homes.***

A tile to compliment today's varied architectural styles, the pace and diversity of modern city living reflected in the strong straight lines of this tile.

LA ESCANDELLA

Product Information

Vienna Product Specifications

Product Specification	
Min Pitch:	15 Degrees with Sarking, 20 Degrees without Sarking
Optimum Set Out:	390mm (+5/- 70mm)
First Batten:	380mm (top of batten)
Sarking:	As noted in “Min Pitch” below
Dimensions:	460mm x 255mm x 30mm
Weight:	3.3kg
Layed:	Straight Bonded
Tiles Per M²:	12.1
Weight per M²:	37.95kg (Tiles Only)
Weight per LM:	3
Ridgers per LM:	2.5
Batten per M²:	2.9
Batten:	600 Centres - 40 x 25 HWD (QLD) / 38 x 38 Pine (NSW, ACT, VIC, SA, TAS) 38 x 25 Karri (WA) 900 Centres - 50 x 38 HWD (QLD, NSW, ACT, VIC, SA, TAS)
Fixing:	Head Lap Clip or Nailed
Pallet Quantity:	180 / 240

Vienna Fittings

Ridges	Apex	Hip End	Double Roll	Barges	Extras
					
Q90 Collarless Ridge	Q111 Collarless 3 Way End Ridge (QLD Only)	Q109 Collarless Hip End Ridge	N/A	Q91 Pyramid Ridge	N/A

## LA ESCANDELLA / VIENNA

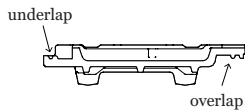
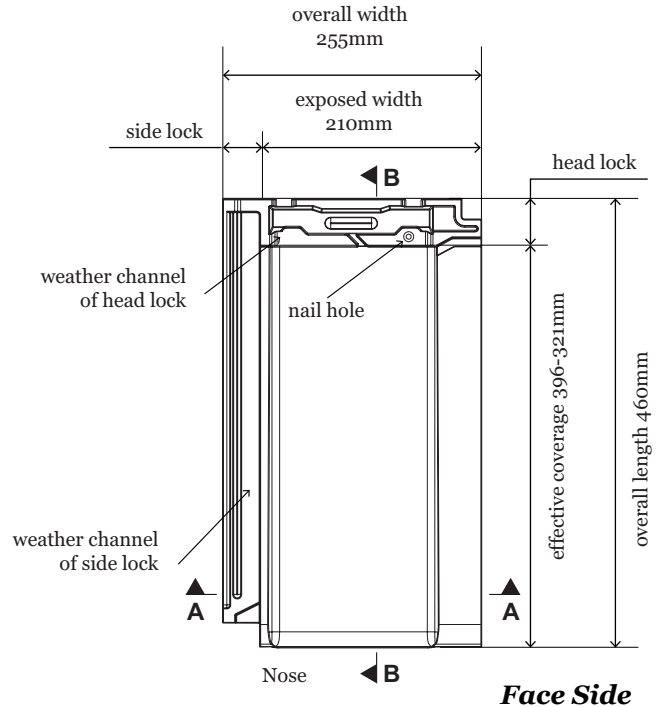
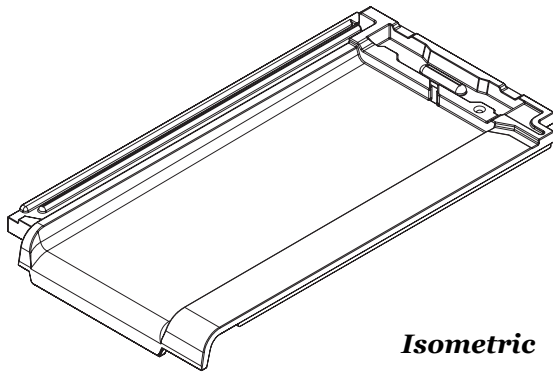
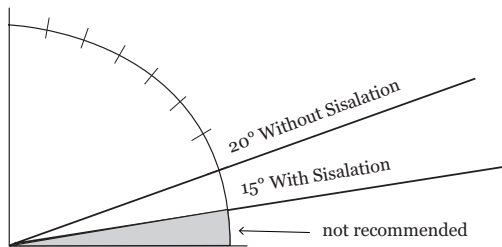
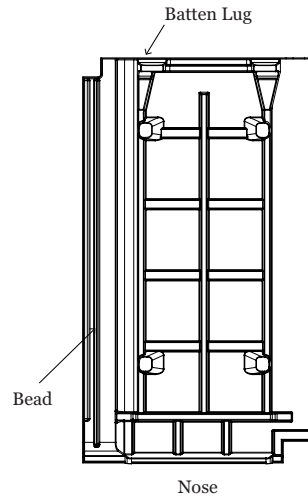
**Vienna Product  
& Test Specification****Section A****Section B****Roof Pitch****Underside**

Testing Standard	Test Description	Std Tolerance	Average Vienna Result
AS - 4046.1	Distortion & Warpage	< 8mm	All Vienna tiles either comply or exceed the standard tolerances listed in this table.
AS - 4046.2	Batten lugs & Squareness	< 1.5% Length	
EN - 538	Transverse Strength	3 Nt/exposed mm of width	
EN - 539-2	Water Absorption	<10%	
EN - 539-1	Permeability	Two hour test	
EN - 539-1&2	Freeze / Thaw	150 cycles	
AS - 4046.7	Resistance to Salt Attack	Exposure	
AS - 4046.8	Dynamic weather resistance	Calibrated Datum	

# LA ESCANDELLA / VIENNA

## Vienna Product Identification & Layout Coursing Information

First course batten should be 20mm higher than all succeeding course battens to provide a consistent course alignment.

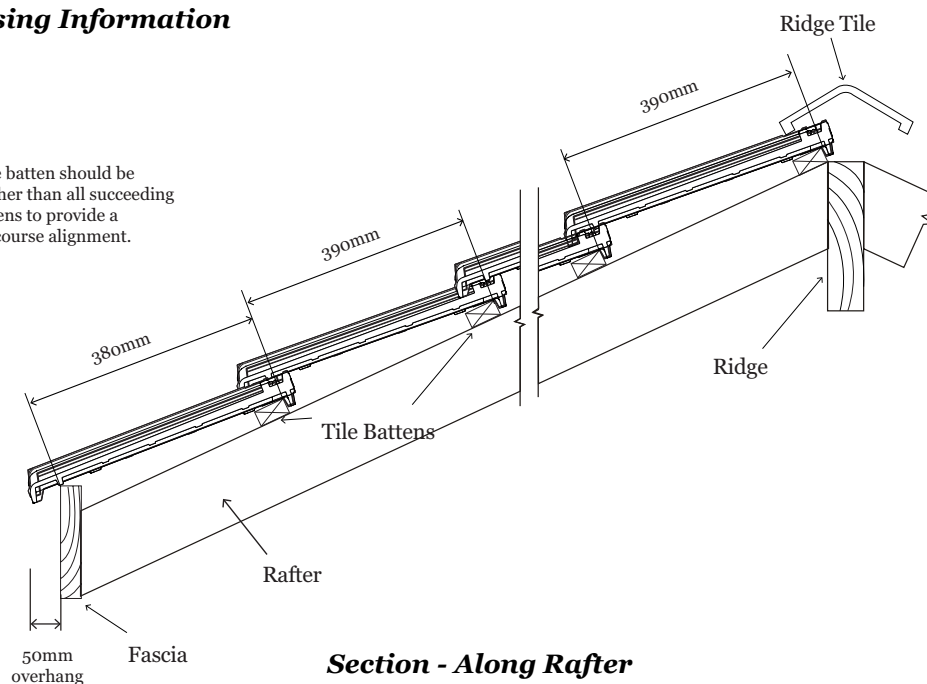

**Section - Along Rafter**

## Vienna cross bonded roof tile laying

- Vienna Roof tile
- Q91 Pyramid Ridge

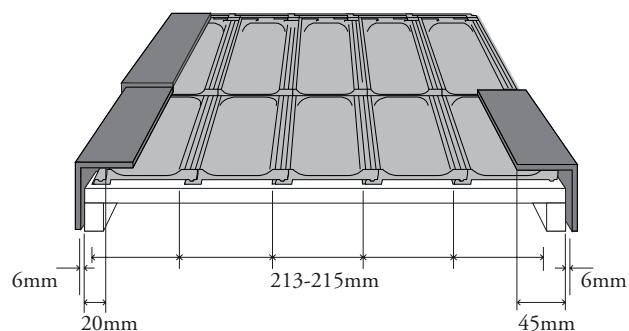



---

LA ESCANDELLA

---

## *Medio Curva*

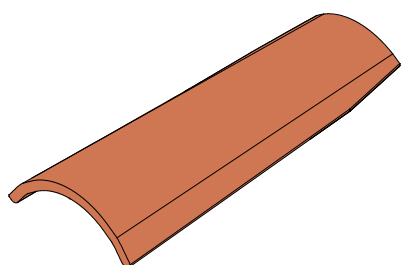

***A roof tile used through the ages, reintroduced in colours designed for the new world.***

Traditionally, this two piece tile, also referred to as 'Mission Barrel', was the most frequently used roof tile in Europe and in Spanish colonial buildings in the new world. Today the Medio Curva tile is used in the construction of new homes, due to the beauty and wide variety of colours available, or on existing projects to restore historic roofs to their former beauty.



## LA ESCANDELLA

## Product Information

*Medio Curva Product Specifications*

Product Specification	
<b>Min Pitch:</b>	10-27 degrees with roof sheets, 27.1+ degrees with batten installation
<b>Optimum Set Out:</b>	See Longitudinal fit information on page 39
<b>First Batten:</b>	See Longitudinal fit information on page 39
<b>Sarking:</b>	N/A
<b>Dimensions:</b>	See Longitudinal fit information on page 39
<b>Weight:</b>	See Longitudinal fit information on page 39
<b>Layed:</b>	Straight Bonded
<b>Tiles Per m2:</b>	See Longitudinal fit information on page 39
<b>Weight per M²:</b>	See Longitudinal fit information on page 39
<b>Cuts per LM:</b>	16
<b>Ridges per LM:</b>	2.5
<b>Batten per M²:</b>	2.9
<b>Batten:</b>	600 Centres - 40 x 25 HWD (QLD) / 38 x 38 Pine (NSW, ACT, VIC, SA, TAS) 38 x 25 Karri (WA) 900 Centres - 50 x 38 HWD (QLD, NSW, ACT, VIC, SA, TAS)
<b>Fixing:</b>	Adhesive
<b>Pallet Quantity:</b>	275

*Medio Curva Tiles & Fittings*

Ridges	Apex	Hip End	Double Roll	Tile	Extras
					
T5	N/A	Q83 Round Hip End Ridge Cap	N/A	T5	N/A

# LA ESCANDELLA / MEDIO CURVA

## Medio Curva Product & Test Specification

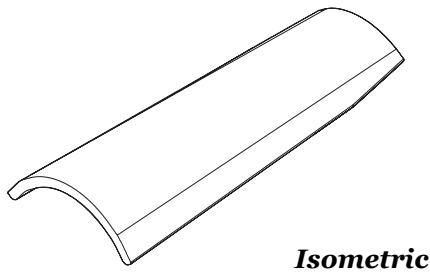

Face Side

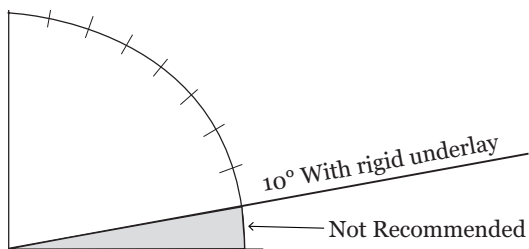
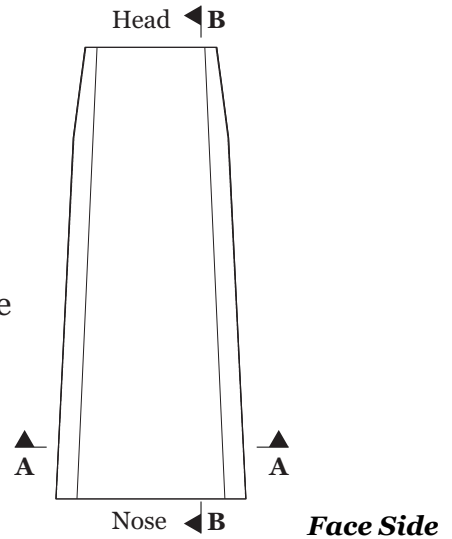

**Roof Pitch**

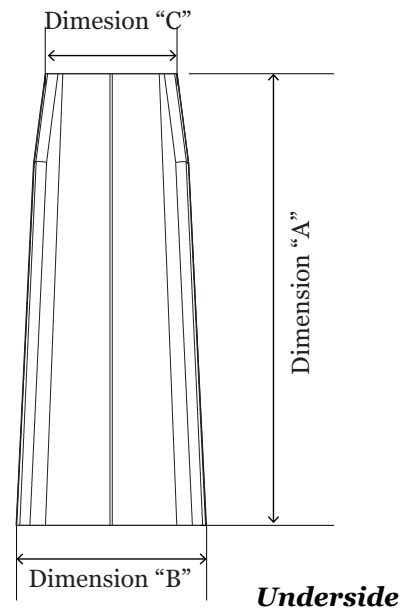

Testing Standard	Test Description	Std Tolerance	Average Medio Curva Result
AS - 4046.1	Distortion & Warpage	< 8mm	All Medio Curva tiles either comply or exceed the standard tolerances listed in this table.
AS - 4046.2	Batten lugs & Squareness	< 1.5% Length	
EN - 538	Transverse Strength	3 Nt/exposed mm of width	
EN - 539-2	Water Absorption	<10%	
EN - 539-1	Permeability	Two hour test	
EN - 539-1&2	Freeze / Thaw	150 cycles	
AS - 4046.7	Resistance to Salt Attack	Exposure	
AS - 4046.8	Dynamic weather resistance	Calibrated Datum	

## LA ESCANDELLA / MEDIO CURVA

**Product Specification Table**

	<b>T4 Red Clay</b>	<b>T4 White Clay</b>	<b>T5 Red Clay</b>	<b>T5 White Clay</b>
<b>Dimensions</b>	a: 396 mm b: 182 mm c: 130 mm	a: 400 mm b: 185 mm c: 134 mm	a: 500 mm b: 210 mm c: 160 mm	a: 500 mm b: 215 mm c: 165 mm
<b>Pieces /m<sup>2</sup></b>	28	28	18	18
<b>Weight piece</b>	1.6 kg	1.5 kg	2.55 kg	2.4 kg
<b>Pieces /pallet</b>	648 / 660	648 / 660	275	275
<b>Average weight (inc. sheet) /m<sup>2</sup></b>	58.7 kg	55.9 kg	59.78 kg	57.08 kg

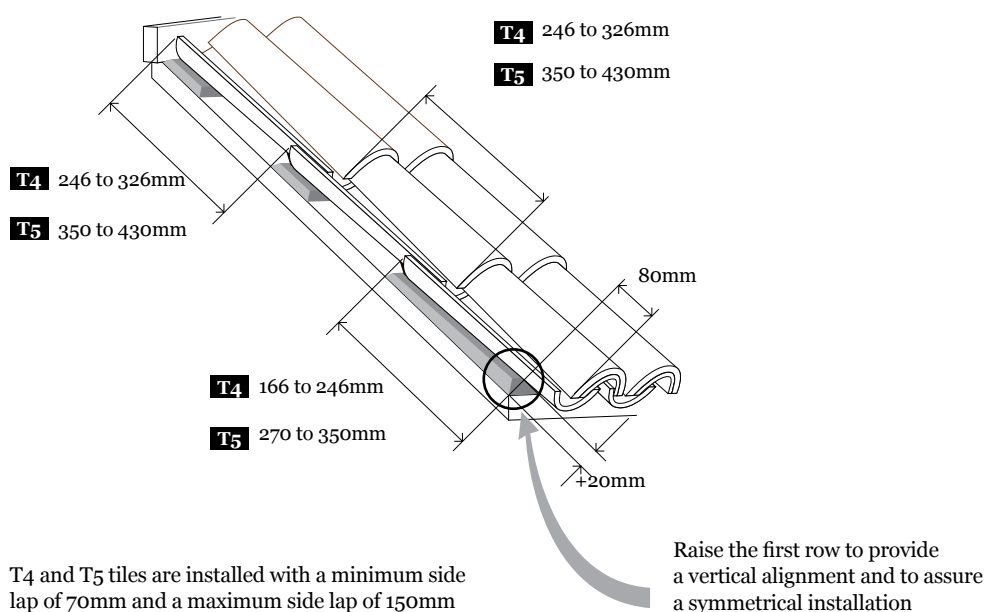
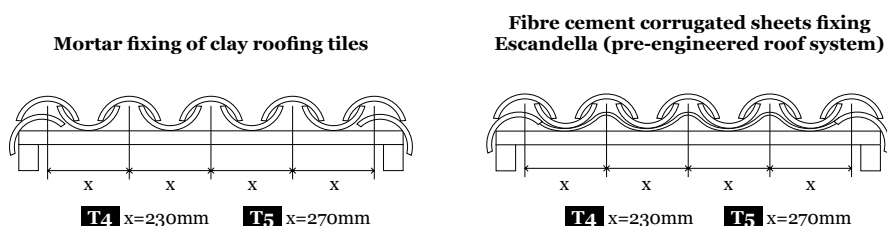
**Medio Curva Product Specification Laying Method****Longitudinal fit****Transversal fit**

# LA ESCANDELLA

## *Clay tile barge*

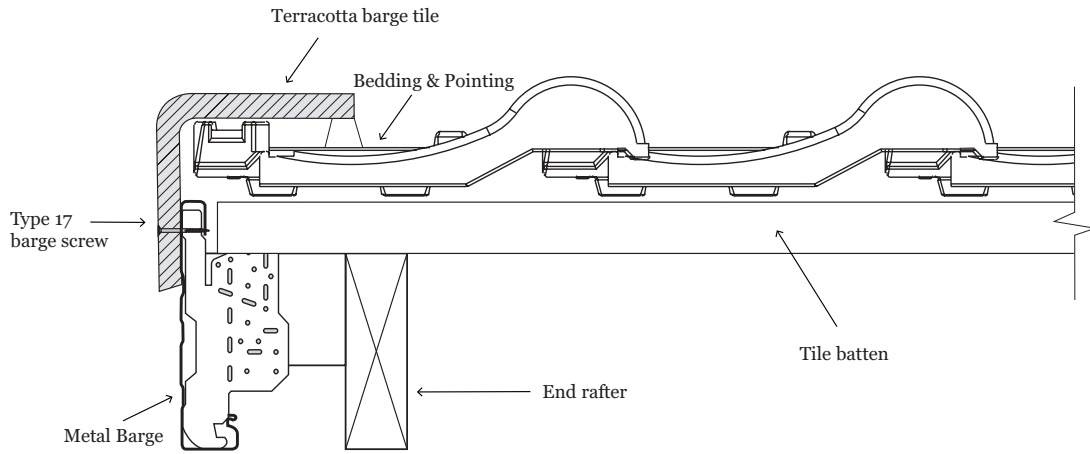

Drawing No. BTR012  
Not to scale Author: Bristile Roofing





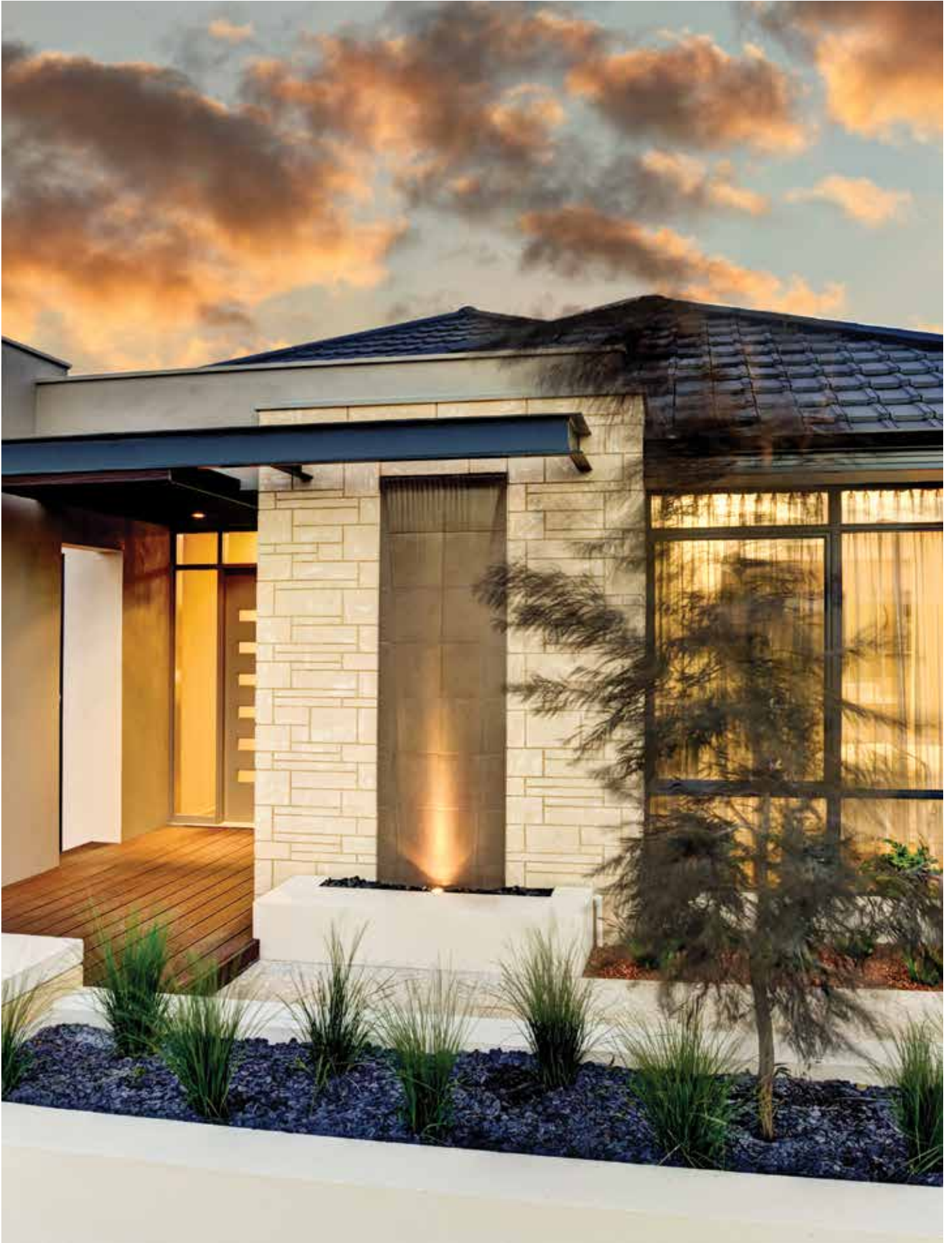

## BRISTILE ROOFING WARRANTIES



Ceramic Roof Tiles are offered with a Colour For Life Warranty. This means that the roof tile you buy is warranted to remain the same colour for the life of the product. No other commonly used roofing material such as concrete roof tiles or metal roofing can make claim.



All roofs installed by Bristile Roofing are offered with a 10 Year Total Roof Warranty. This warranty states that we guarantee the roof has been installed properly and that the roof tiles and all accessory products are guaranteed against defect for a period of 10 years\*.



Selected Ceramic Roof Tiles are offered with a 50 Year Product Warranty which means the product is guaranteed to remain structurally sound and is free of manufacturing faults for a 50 year period.



Selected Ceramic Roof Tiles are offered with an industry leading 100 Year Product Warranty which means the product is guaranteed to remain structurally sound and is free of manufacturing faults for a 100 year period.

### *Roofing Warranties. The Simple Facts*

There are a number of roofing materials to choose from with a vast range of differing warranties, often written in legal jargon and terms that most people would have trouble understanding.

Below are the simple facts comparing Bristile Roofing's warranties with the leading alternative, metal roofing.

	Warranty applies to product installed within 200m of breaking surf	Warranty applies to product installed within 500m of salt water	Roof must be cleaned bi-annually to maintain warranty*	Warranty applied to colour longevity
<b>COLOUR FOR LIFE WARRANTY</b> CERAMIC ROOF TILES	YES	YES	YES	YES
<b>50 AND 100 YEAR PRODUCT WARRANTY</b> CERAMIC ROOF TILES	YES	YES	NO	NO
<b>36 YEAR EXTENDED WARRANTY</b> METAL ROOFING	NO	NO	YES	NO

\* Areas not normally exposed to rain must be hosed every six months  
All information is correct at the time of printing.





# WE ARE

## *Brickworks*

Brickworks Building Products is one of Australia's largest and most diverse building material manufacturers. Under the Brickworks Building Products umbrella are some of Australia's best known building materials brands. Our products include bricks, pavers, masonry blocks, retaining wall systems, precast concrete panels, concrete and terracotta roof tiles, timber products and specialised façade systems.

With a broad product portfolio and manufacturing and sales facilities across Australia, Brickworks Building Products is uniquely placed to service the demands of the building industry.

With over 1200 staff across Australia and New Zealand, we pride ourselves on our commitment to product, service excellence and our leadership position.

**BRICKWORKS**  
BUILDING PRODUCTS

 **australbricks**  
SINCE 1908

 **australmasonry**

 **australprecast**

 **auswesttimbers**

 **bristileroofing**

 BOWRAL BRICKS

**nubrik**  
authentic brickwork



**terraçade**  
TERRACOTTA FAÇADE SYSTEMS

**INEX > BOARDS**

**Pronto Panel**





**bristileroofting.com.au | 1300 274 784**

#### **DESIGN STUDIOS**

##### **Sydney**

2 Barrack Street,  
Sydney  
NSW 2000

##### **Melbourne**

Ground Floor  
367 Collins Street,  
Melbourne  
VIC 3000

##### **Brisbane**

27 James Street,  
Fortitude Valley  
QLD 4006

##### **Adelaide**

Ground Floor  
70 Hindmarsh  
Square, Adelaide  
SA 5000

##### **Perth**

67 King Street,  
Perth  
WA 6000

##### **Hobart**

9 Franklin Wharf,  
Hobart  
TAS 7000

Proud Supporters



**BRICKWORKS**  
— BUILDING PRODUCTS —

Bristile Roofing is part of the Brickworks Group

The product images shown in this brochure give a general indication of product colour for your preliminary selection.  
Bristile Roofing recommends all customers see actual product samples at a selection centre prior to making final selections.

03/2020