

A LEGACY IN BRICK



2021 Brick Collection

CONTENTS

04 A LEGACY IN BRICK

06 UNIQUE CHARACTER AND STYLE

08 CARBON NEUTRAL BRICKS

10 DESIGNED TO LAST

12 CRAFTED CLAY BRICK COLLECTION

16 CASE STUDIES

20 MORTEX

21 PRODUCT INFORMATION

22 STYLE INSPIRATION

24 HOME OF DESIGN

26 BEAUTIFUL PRODUCTS THAT LAST FOREVER



PRODUCT: HAWTHORN, LONDON | ARCHITECT: MATYAS ARCHITECTS | PHOTOGRAPHER: TATJANA PLITT

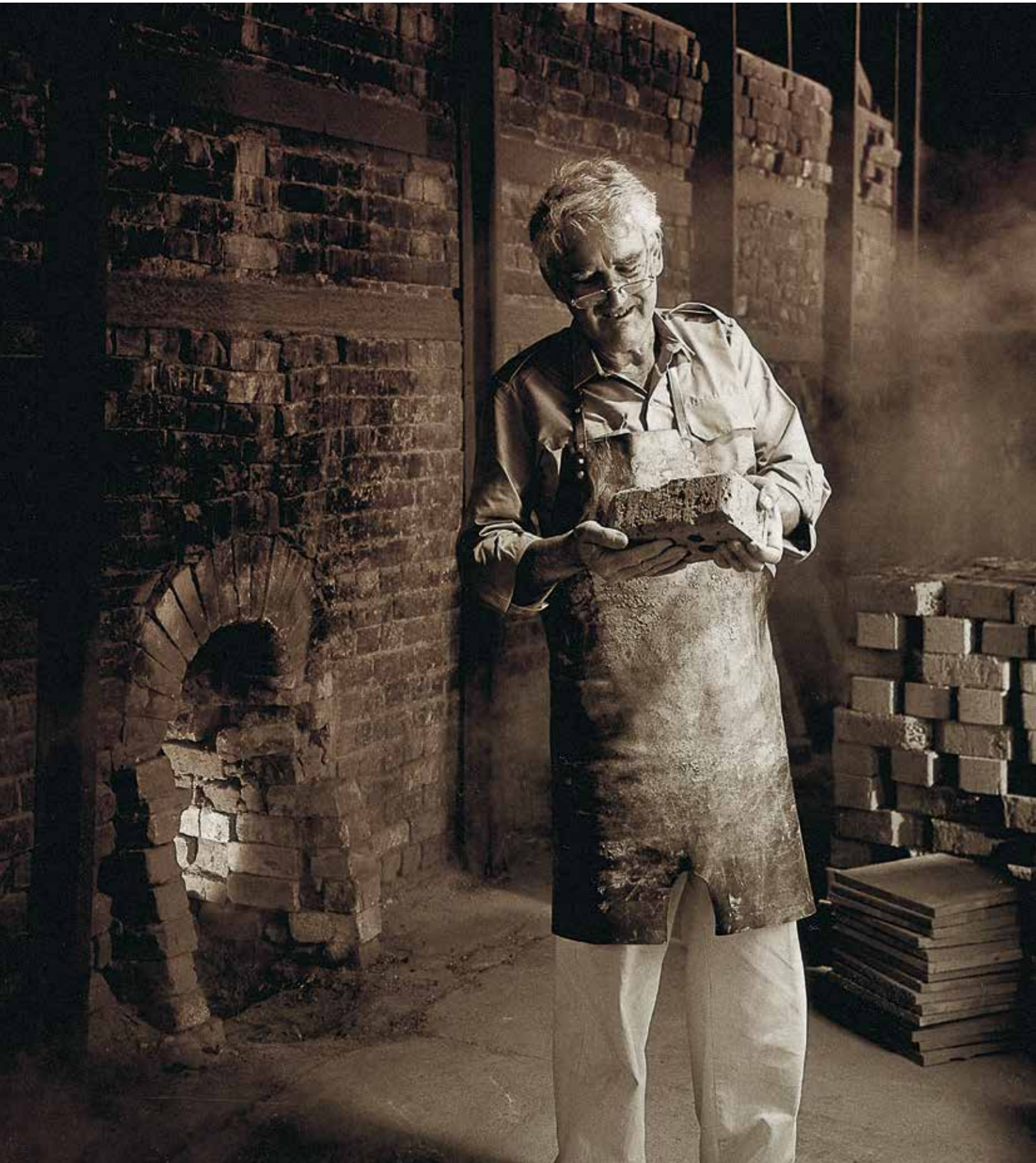

A LEGACY IN BRICK

The story of Daniel Robertson begins in 1853 when John Robertson imported Welsh roofing slates as ballast in sailing ships into Melbourne.

He was soon providing all forms of roofing, including terracotta tiles, across his newly adopted hometown and in 1910 the company commenced its first manufacturing venture producing concrete roof tiles in Whiteman Street, South Melbourne.

To this day, many of Melbourne's most notable buildings still feature those original, Daniel Robertson roofs. But it wasn't until 1928 that the company sealed its reputation for quality craftsmanship after acquiring Tunstall Brickworks in Nunawading and converting it for the production of terracotta tiles.

The transition to red clay products proved extremely successful and business grew rapidly. By 1967 the company was a leader in the field, researching and developing new colours, shapes and textures.

In that same year, it launched a unique range of rustic bricks as an alternative to the smooth-faced options only available at the time.

They were an instant hit.

Demand for this new product soon became so great that roof tile production was phased out within two years to focus on manufacturing bricks.

In 2012 Australia's largest building products manufacturer Brickworks Building Products group acquired the company. Under this well respected banner, Daniel Robertson continues to deliver excellence and innovation in architectural brickwork.

There are simply no better premium quality bricks available today.

UNIQUE CHARACTER AND STYLE

In a world of mass production, these crafted clay bricks are highly valued for their unique character, earthy appeal and individual charm. Developed through years of tradition, they are kiln fired to produce bricks which have distinctive colour and textural variations.

PRODUCT: HAWTHORN 50, LONDON | ARCHITECT: K2LD ARCHITECTURE | PHOTOGRAPHER: AARON POCKOCK

SUSTAINABLE AND CARBON NEUTRAL

Daniel Robertson bricks made in Tasmania have achieved the enviable goal of Carbon Neutral certification under the Australian Government's National Carbon Offset Standard. This feat has been largely achieved by using sawdust as the main firing fuel for our kilns at our Longford plant. Thermal mass, energy-efficient design, reusability, and the fact that bricks do not require resource-hungry finishes such as paint or render to maintain their good looks and durability, all add to our sustainability credentials.

PRODUCT: HAWTHORN 470, OXFORD

Sustainability is important to us and we are committed to being concerned for and respecting the environment. Daniel Robertson bricks are certified carbon neutral which means that they have no net impact on the climate. We are taking responsibility for our emissions through energy efficient production methods and investing in reforestation and renewable energy projects. Visit climateactive.org.au for more information about our carbon neutral certification.

PRODUCT: HAWTHORN 470, OXFORD





PRODUCT: HAWTHORN, LONDON | ARCHITECT: NATYAS ARCHITECTS | PHOTOGRAPHER: TATJANA PLITT

DESIGNED TO LAST

Versatile in design, durability to last a lifetime, the highest thermal comfort and with low maintenance upkeep, clay bricks tick all the boxes for homes and projects with value and sustainability in mind.

LOW MAINTENANCE

No need to paint or other treatments to maintain their aesthetics and durability. They are strong, reliable and relatively maintenance free.

AFFORDABLE

Cost effective building product materials that increase the value of your investment or project from day one, for generations to come.

ENERGY EFFICIENT

Combined with intelligent passive building design elements, clay bricks can help moderate building temperatures and reduce energy consumption.

STRENGTH AND SAFETY

Clay products are stronger than other light weight materials and also provide a safer and more secure home from the outside environment.

SUSTAINABLE

Clay is a natural resource which has been used for centuries because it retains its colour forever as well as its durability. Architects, engineers and specifiers continue to appreciate the advantages of using clay products.

100 YEAR
PRODUCT WARRANTY

peace of mind guaranteed

Daniel Robertson bricks are backed by an exclusive Brickworks 100 year warranty.

STYLE INSPIRATION

DANIEL ROBERTSON HAVE THE INSPIRATION AND EXPERTISE YOU NEED

With our comprehensive series of colour and style palettes, skillfully curated from the huge range of Brickworks building materials available, you can select a thoughtful and stylish scheme for any house, whether it's cutting edge contemporary or more traditionally influenced.

Just as important, clay is a natural resource which has been used for centuries because it retains its colour forever as well as its durability.

Our expert design consultants can talk you through colour and style swatches in a friendly one-to-one session, helping you pick a scheme you love for your vision.

BOOK YOUR ONE-ON-ONE colour consultation TODAY

For more style inspiration or to book an appointment, please visit our website:
danielrobertson.com.au



COLOUR SCHEME: SIENNA

NEW ARRIVALS



THE OVERLAND RANGE

As we move towards a more sustainable future, the need for genuine connection to the land is increasing. What better place to start than the moody landscapes and rich flora of our wild island state; from the dark grey rock formations of the brooding coast of North West Tasmania, to the warm buff browns of the Huon Valley pines and the red clays and white sands of Freycinet.

This stunning collection has a unique DNA that can be traced back to Tasmania’s earliest hand-crafted colonial buildings. Still proudly made in Tasmania, today’s cutting-edge techniques are the result of meticulous research and design insights, that has resulted in a range which is proudly carbon neutral.

Just like the magnificent wide-ranging beauty of Tasmania, each brick has been created so each double-face is inherently unique in colour and form, but with an extraordinarily natural ‘reclaimed’ feel. Much the same as the weathered landscapes that inspired this collection, these bricks will delight for generations to come.

Pristine



Tarkine GP ●



Huon GP ●



Freycinet GP ●



Cradle GP ●

Rugged



Tarkine GP ●



Huon GP ●



Freycinet GP ●



Cradle GP ●



PRODUCT: OVERLAND PRISTINE, CRADLE



DANIEL ROBERTSON CRAFTED CLAY BRICK COLLECTION

TRADITIONAL

Daniel Robertson and its range of clay bricks are still as popular today as they were 50 years ago when the company was first established. With their highly textured face and complex multi layered colouring, the unique attributes of the Traditional premium bricks offer real individuality and distinction. The discerning architect, premium builder and sophisticated homeowner will appreciate their authentic, individual appearance.

FEATURED: RED

TRADITIONAL 50

This clay brick has all the rustic charm of the standard Traditional, but with a modern, sleek format. The slimline bricks in the 50 series make them ideal for feature wall applications or projects that call for a contemporary aesthetic and feel. Generations of brickmaking have refined its crafting and like the standard Traditional format all colours are classified carbon neutral.

FEATURED: APRICOT

HAWTHORN

This range echoes the iconic Hawthorn brick that gives so many of Melbourne's historic inner city homes their distinct character. The Hawthorn range captures red, tan and brown base clay colours, and are further highlighted with dark and strong blue char and black frit, giving them a rich historic ambience. When combined with Daniel Robertson's heavy textured face, the result is that no two clay bricks are the same, lending it a truly unique, handmade aesthetic.

FEATURED: TAN

HAWTHORN 50

This clay brick features the heavily textured face of the Hawthorn in a slim yet elegant profile. Its compact and thoroughly modern appearance makes it ideal for feature wall applications or projects that call for a distinctly contemporary look.

FEATURED: LONDON

*Classified carbon neutral

HAWTHORN

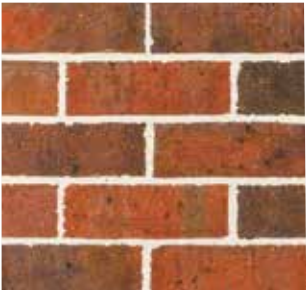

Red*

GP



Tan*

GP



Black*

GP



Cambridge*

GP



London*

GP

HAWTHORN 50

*Classified carbon neutral

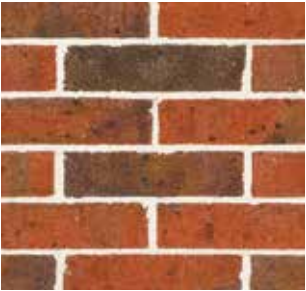

Red*

GP

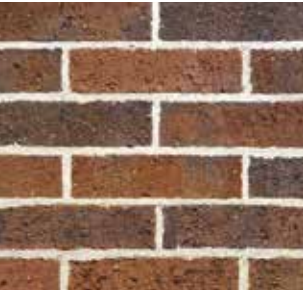

Tan*

GP

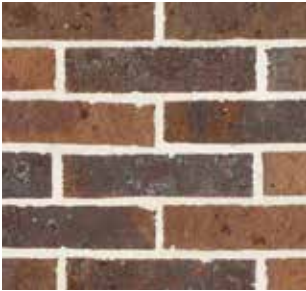

Black*

GP



Cambridge*

GP



London*

GP

SIZING

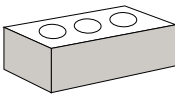

Hawthorn
230 L x 110 W x 76 H mm

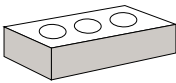

Hawthorn 50
230 L x 110 W x 50 H mm

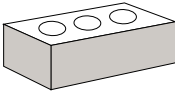

Traditional
230 L x 110 W x 76 H mm

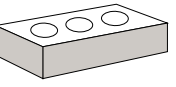

Traditional 50
230 L x 110 W x 50 H mm

*Classified carbon neutral

TRADITIONAL



Buff*

GP



Dulwich Grey*

GP

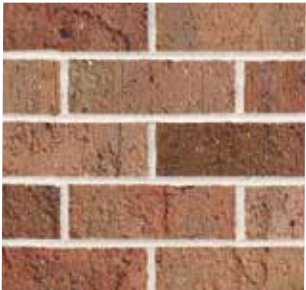

Apricot*

GP

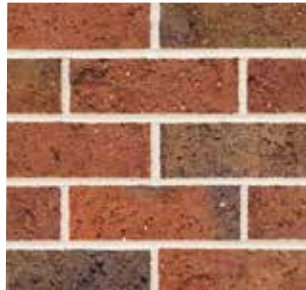

Red*

GP



Grey Blend*

GP

TRADITIONAL 50

*Classified carbon neutral



Buff*

GP

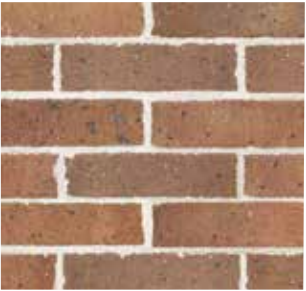

Dulwich Grey*

GP

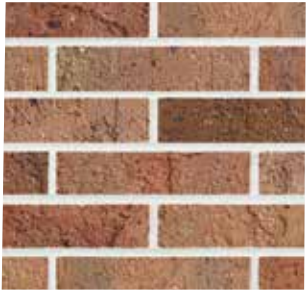

Apricot*

GP

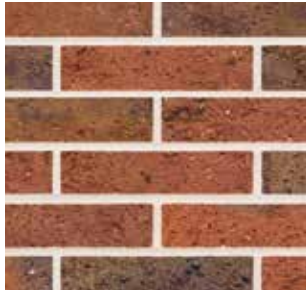

Red*

GP

SPECIAL SHAPES

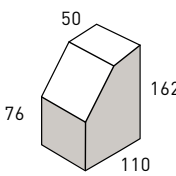

SILL

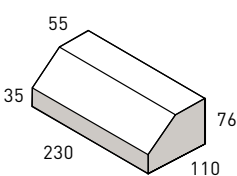

PLINTH STRETCHER

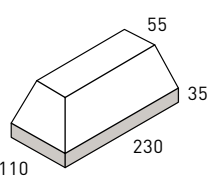

PLINTH LH EXTERNAL RETURN

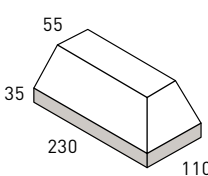

PLINTH RH EXTERNAL RETURN

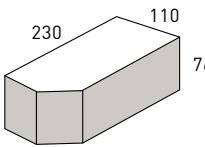

SINGLE CANT

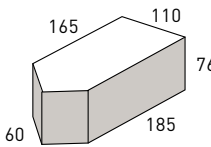

45 DEGREE SQUINT



PRODUCT: TRADITIONAL50, RED | ARCHITECT: MATT GIBSON ARCHITECTURE + DESIGN | PHOTOGRAPHER: SHANNON MCGRATH

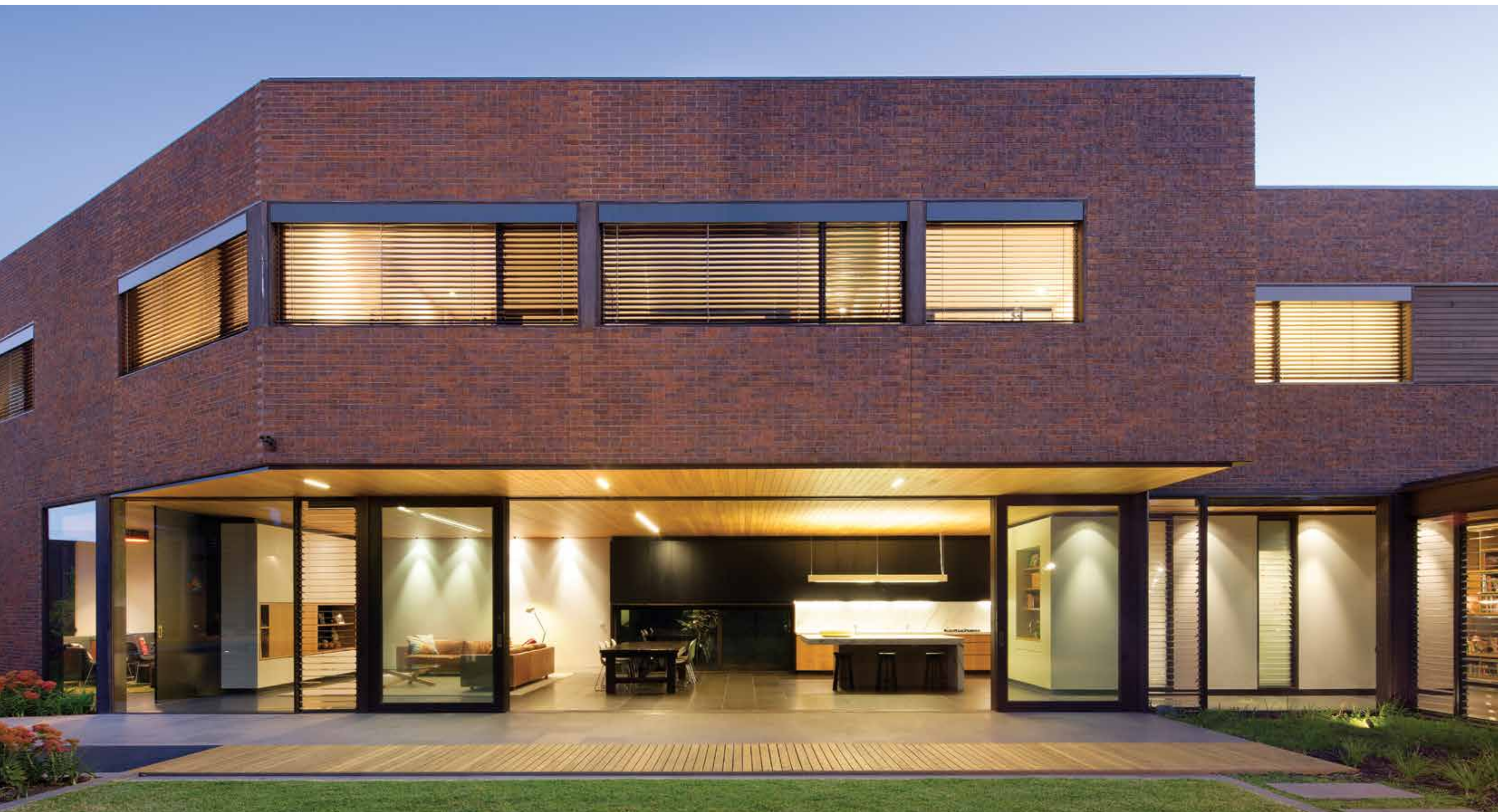

PRODUCT: HAWTHORN 50, LONDON | BUILDER: BD PROJECTS | PHOTOGRAPHER: JOHN GOLLINGS

MORTEX

Mortar colour and mortar finishes

MORTEX is a factory manufactured, quality assured premixed M4 rated mortar solution. Its consistency can save labour time, increase efficiency, remove the need for on site blending, and it is compliant with AS3700:2018. MORTEX takes the guess work out of mortar blending and reduces the potential for under strength, non compliant mortar use.

MORTAR COLOURS

White mortar is currently the most popular colour. This is made by mixing light coloured cement and white sand and results in a traditional brick and mortar look. Mortar can be coloured by adding powdered or liquid pigments to the mortar as it is being mixed by the bricklayer. It can also be tinted to

This can ultimately reduce potential liabilities, saving money and time on rectifications. With the adoption of ISO9001:2008 principles, the mortar constituents are accurately measured and blended in a controlled environment to ensure consistent, homogeneous mortar is produced on-site.

match the brick colour, giving a very even wall colour. Please confirm with your bricklayer what their mortar colouring offering is before making your final decision.

For more information on MORTEX please contact us on 13-Brick (13-2742).

STANDARD

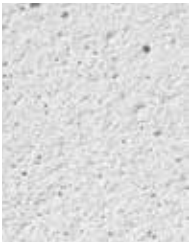

MORTEX White



MORTEX Grey



MORTEX Charcoal

Please refer to the MORTEX Charcoal Technical Data Sheet for installation and cleaning guidelines before use.

CUSTOM



Limestone



Pebble



Bark



Pewter



Nickel



Oak



Gumnut

MORTAR FINISHES

There are four common mortar finishes and these various finishes result in different shadow lines on the wall. A raked finish will create a deep shadow in the mortar joint. This brings out the horizontal lines of the brickwork (and the vertical lines to a lesser extent) and it is the most common finish. Ironed and struck joints also create shadow lines, but these are much finer and more subtle. A flush joint doesn't allow shadow lines to form at all, giving the wall a flatter, more unified look. Using a mortar colour to match the brick will take this a step further.

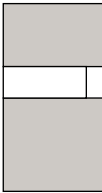

Raked

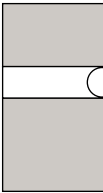

Ironed

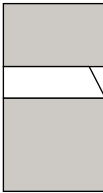

Struck

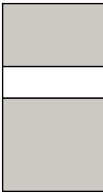

Flush

PRODUCT INFORMATION

Collection	Range	Colour	Durability Class	Solar Rating	Colour Group	Colour Scheme	Size	Carbon Neutral
DANIEL ROBERTSON	OVERLAND PRISTINE & RUGGED	Cradle	GP	D	Blackish	Raven	230mm x 110mm x 76mm	Yes*
		Freycinet	GP	D	Red	Rouge	230mm x 110mm x 76mm	Yes*
		Huon	GP	D	Tan	Bisque	230mm x 110mm x 76mm	Yes*
		Tarkine	GP	D	Tan	Bisque	230mm x 110mm x 76mm	Yes*
	TRADITIONAL	Apricot	GP	M	Tan	Bisque	230mm x 110mm x 76mm 230mm x 110mm x 50mm	Yes*
		Buff	GP	M	Tan	Bisque	230mm x 110mm x 76mm 230mm x 110mm x 50mm	Yes*
		Dulwich Grey	GP	D	Tan	Bisque	230mm x 110mm x 76mm 230mm x 110mm x 50mm	Yes*
		Grey Blend	GP	D	Tan	Bisque	230mm x 110mm x 76mm	Yes*
	HAWTHORN	Red	GP	D	Red	Rouge	230mm x 110mm x 76mm 230mm x 110mm x 50mm	Yes*
		Black	GP	D	Brown	Sienna	230mm x 10mm x 76mm 230mm x 110mm x 50mm	Yes*
		Cambridge	GP	D	Tan	Bisque	230mm x 110mm x 76mm 230mm x 110mm x 50mm	Yes*
		London	GP	D	Blackish	Raven	230mm x 110mm x 76mm 230mm x 110mm x 50mm	Yes*
		Red	GP	D	Red	Rouge	230mm x 110mm x 76mm 230mm x 110mm x 50mm	Yes*
		Tan	GP	D	Brown	Crema	230mm x 110mm x 76mm 230mm x 110mm x 50mm	Yes*

*When manufactured in Longford, Tasmania.

EXP = Exposure grade

Suitable for use in external walls exposed to aggressive environments, such as; areas subjected to salts in the soil, adjacent material or ground water, in coastal areas exposed to attack from windborne salt spray, or retaining walls subjected to fertilisers and ground salts.

GP = General purpose

Suitable for internal and external walls only when above a sheet or membrane damp-proof course and protected by an adequate coping, eaves, roof or similar top covering. These units should not be directly exposed to saline environments.

Solar absorptance rating

In the design of energy efficient buildings, the architects and consulting engineers need to be able to calculate the heat loss or gain of materials used to construct these buildings.

For this reason, our product range has been categorised into three colour groups

Light (L) < 0.475
Medium (M) 0.475 - 0.70
Dark (D) > 0.70

to assist architects and consulting engineers with their calculations.

HOME OF DESIGN

Brickworks Design Studios and Design Centres are the place to get inspired and excited about your project.

Our extensive and innovative range of building solutions are all on display within our Brickworks Design Studios and Design Centres. A free one-to-one colour consultation with a Brickworks design expert allows you to feel the textures and experience the quality first hand, giving you ideas and bringing your new home to life.

brickworks.com.au/colour-consultations/

And now, with our online colour visualisation tool, iVisualise, you can experiment and choose what your new home will look like online, making the process of selecting your external colours and finishes a stress-free experience.

australbricks.com.au/ivisualise

Backed by Brickworks

Local expertise. Global quality. Brickworks Building Products is one of Australia's biggest building material producers. With heritage going all the way back to one of Australia's founding brick producers, we're proud of our reputation for design, innovation and sustainability.

BRICKWORKS

AUSTRALIA















NORTH AMERICA

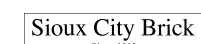

EXCLUSIVE DISTRIBUTOR





Visit. danielrobertson.com.au
Call. 13 Brick

Design Studios

Sydney 2 Barrack Street Sydney NSW 2000 02 9611 4200 sydneydesignstudio @brickworks.com.au	Melbourne Ground Floor 367 Collins Street Melbourne VIC 3000 03 8621 7777 melbournedesignstudio @brickworks.com.au	Brisbane 27 James Street Fortitude Valley QLD 4006 07 3634 5604 brisbanedesignstudio @brickworks.com.au
Adelaide Ground Floor, 70 Hindmarsh Square Adelaide SA 5000 08 8443 2222 adelaiddesignstudio @brickworks.com.au	Perth 67 King Street Perth WA 6000 08 6332 5800 perthdesignstudio @brickworks.com.au	Hobart 210 Elizabeth Street North Hobart TAS 7000 03 6212 9120 hobartdesignstudio @brickworks.com.au

Follow Us



Visit. danielrobertson.com.au

Call. 13 Brick

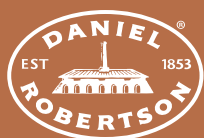

BRICKWORKS