

Masonry

—
Spring Summer
Product Release 2020



BRICKWORKS

What's inside:

- 1 – Urbanstone p⁰⁶
- 2 – GB Masonry p²⁴
- 3 – Austral Masonry p⁴⁰
- 4 – Contact p⁶²

Spring Summer 2020



Lasting Impressions



Masonry has come a long way in recent years, giving outdoor spaces colour, strength, shelter and presence. With colours, sizes and textures inspired by Australian landscapes, your projects will seamlessly fit in – or stand out – in any environment you choose.

Our New Spring Summer Range

—

Urbanstone



Accolade P.08

Crafted for outdoor spaces, the Accolade range comes with an innate sense of architectural gravitas while scoring high in the style stakes.



Keope P.16

The perfect harmony of beauty and form, Keope Ceramiche porcelain stoneware is made in Italy, and desired the world over.

GB Masonry



Kite Breeze P.26

GB Masonry and designer Adam Goodrum have created a unique, bold and forward-thinking design that's as original as it is functional.

From the decades of durability with our GB Latitude range to the rustic charm of our Magnumstone Ledgeface blocks, we've carefully curated this range to offer the widest of possibilities, yet with the same considered design edge to make your project really stand out. All with the timeless look and enduring visual appeal that makes our masonry loved by leading architects, builders and homeowners.

GB Masonry (continued)



GB Latitude P.32

GB Masonry's latest cladding product, GB Latitude, offers a chance to make memories that will last a lifetime.

Austral Masonry



Magnumstone Ledgeface P.42

Magnumstone Ledgeface is a product designed to blend in to the landscape with an unrivalled sensitivity, crafted with an impeccable attention to detail.



Explorer P.48

Both subtle and sleek, Explorer was crafted to blend in to any project whether commercial or residential.

Urbanstone

—

Accolade p⁰⁸

Keope p¹⁶





Accolade

URBANSTONE®

Beautiful pavers, precision engineered for
outstanding structural integrity.

—

For Urbanstone, a brand synonymous with generations of heritage and class, reverse engineering an aesthetically unmatched paver, high in form and function, has resulted in a market first.

—

Crafted for outdoor spaces, the Accolade range comes with an innate sense of architectural gravitas while scoring high in the style stakes. As a small format paver that's big on designer looks and uncompromising in its ability to meet and exceed manufacturing standards, its creation is no mean feat.

Just like its more traditional predecessors, Accolades are cast from sand, stone and cement, making them the ideal choice for multi-use communal spaces as well as residential and commercial projects.



From left to right: Cloud Grey, Desert Sand, Golden Tan, Ivory White, Natural Beige





Colours

Available in five different nature-inspired colourways, the range showcases soft shell-like whites, muted ochres and cool blue-greys, each a sympathetic response to Australia’s great and varied landscape that stretches from mountain to sea.

Colours

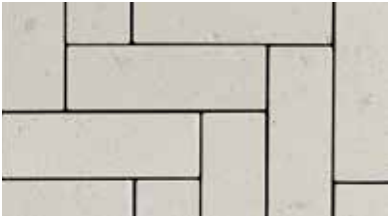

Ivory White

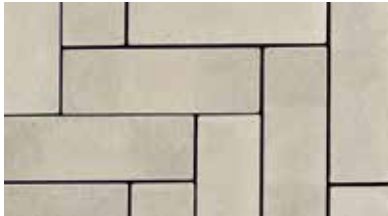

Desert Sand

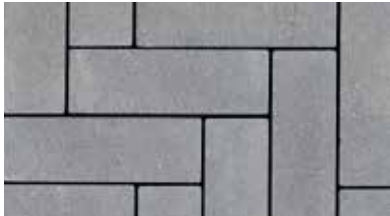

Cloud Grey

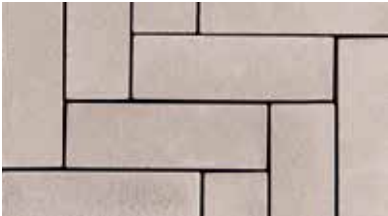

Natural Beige



Golden Tan

Types



Accolade Paver

Size: 230L x 76W x 60H mm

Weight: 5kg

Slip rating: P5



From left to right: Cloud Grey, Desert Sand, Golden Tan, Ivory White



Keope

URBANSTONE®

Elegant Italian porcelain stoneware to complement
any project, inside and out.

—

Bella figura, the true elegance of Italy. The perfect harmony of beauty and form.

—

Ceramiche Keope porcelain stoneware is made in Italy, and desired the world over.

There is no greater inspiration than the textures, colours and patterns of the natural landscape. The refined colours and natural details of each collection enhance both indoor and outdoor spaces with an authentic natural character.

We blend our inspiration from nature with constant research and innovative production techniques. This allows the enhanced natural details of Ceramiche Keope, in combination with their superior technical performance, to create an exquisite range of porcelain stoneware.



Stylish, seductive and quintessentially glamorous, Italian craftsmanship has always been synonymous with luxury, quality and tradition.

—





Colours and types

In the tradition of the finest Italian couture, diversity of colour, texture and finish are an essential element of our products. With collections embracing both natural and contemporary inspirations in complementary aesthetics, there are tones and finishes for every setting.

Colours

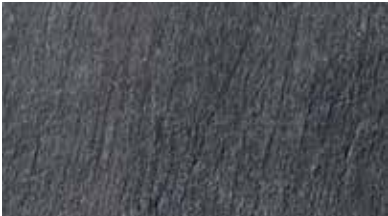

Percorsi | Black



Percorsi | Pietra Di Combe



Percorsi | Pietra Di Bagnolo



Percorsi | Pietra Di Barge



Percorsi | White



Soul | Walnut



Soul | Grey

Types

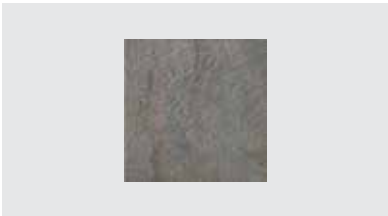

Percorsi

Size: 596L × 596W × 20H mm

Weight: 16.9kg

Slip rating: P5

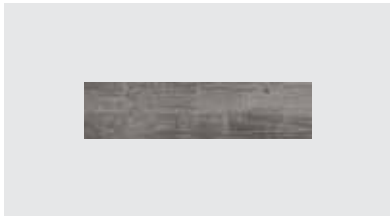

Soul

Size: 1200L × 300W × 20H mm

Weight: 15kg

Slip rating: P5



Percorsi Collection – From left to right: Grey, Pietra Di Bagnolo, Pietra Di Combe, Black

GB Masonry

—

Kite Breeze p²⁶

GB Latitude p³²

2



From left to right: Terracotta, White

Kite Breeze



A contemporary re-imagining of the breeze block
in collaboration with Adam Goodrum

—

GB Masonry and designer Adam Goodrum have created a unique, bold and forward-thinking design that's as original as it is functional.

—

A collaboration with Adam Goodrum

Adaptable and flexible, Kite offers unlimited scope – and is equally at home in domestic settings, or large scale public projects. All with the engineering excellence and high performance you've come to expect from GB Masonry.

Kite is a contemporary re-imagining of the celebrated late modernist era breeze block which made its mark across the world in the 1960s and 1970s. Using new technology and advanced manufacturing that would have made them near impossible to realise just a few years ago – GB Masonry and designer Adam Goodrum have created a unique, bold and forward-thinking design that's as original as it is functional.

"It's been a rewarding collaboration re-imagining the breeze block with GB Masonry – transforming an icon of the past into a new experience for today."

—





Colours

Kite’s naturally bold or gently subtle hues are influenced by some of the breathtaking natural features of Western Australia. Indoors or out, the three colour tones will accentuate and complement any configuration you create.

Colours

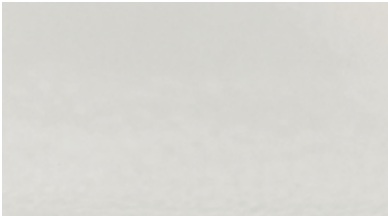

White



Dune



Terracotta

Types



Kite Breeze

Size: 290 x 290 x 90mm

Weight: 5.8kg



From left to right: White, Terracotta



From left to right: Pebble, Pewter, Sandstone, Limestone

GB Latitude



Highly flexible blocks for creating uniquely
modern facade designs.

—

This innovative design is just as much at home among Hamptons-inspired builds as it is creating modernist angles or heritage facades. GB Latitude offers a chance to make memories that will last a lifetime.

—

A true chameleon of style, its hidden perpendicular mortar joints create a feeling of continuity and clean sight lines while its angled face casts shadows that provide a sense of depth and intrigue while having the dual purpose of a practical drainage solution. The GB Latitude range offers a more durable and stylish alternative to weatherboard, or, if you're looking for a unique facade option, then the design possibilities afforded by the customisable patterns are truly endless.

As an exposure-grade concrete product, its ability to endure the harsh Australian climate makes it the ideal choice for those interested in creating homes that are built to last. But what is substance without style? A range of colours, inspired by contemporary architectural trends and Australia's natural landscape, have been given GB Masonry's highly sought-after honed finish, exposing the aggregate and allowing the natural character of the product to shine, while creating a textural experience that elevates any design to the next level.



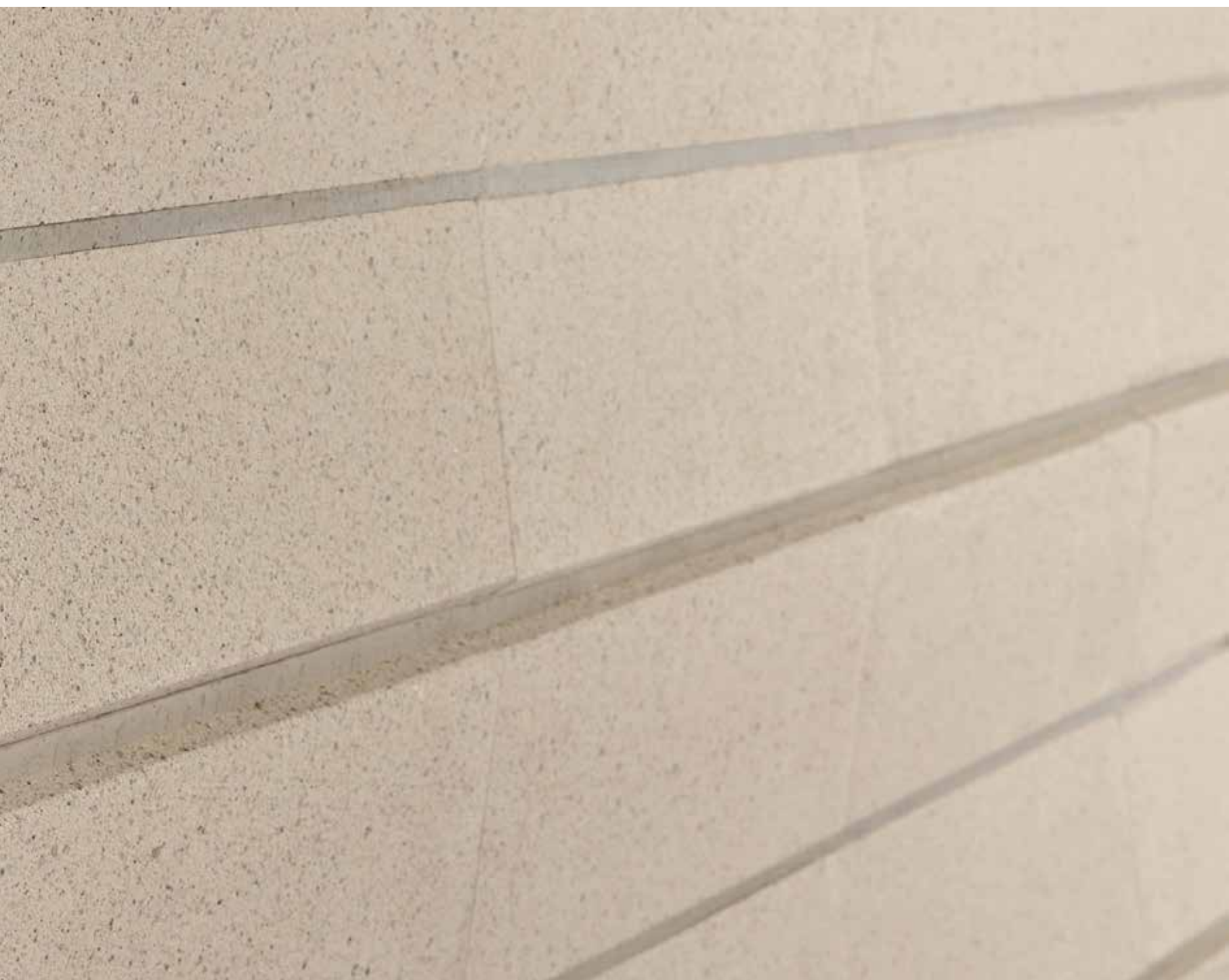



From left to right: Sandstone

Colours and types

Whatever finish you’re looking for, the GB Latitude collection, named for their natural influences such as Porcelain, Limestone, Pebble, Sandstone, Nickel and Pewter, offers an array of captivatingly modern hues that are sure to make a style statement.

Colours

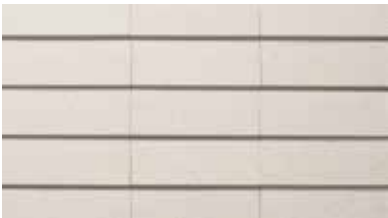

Porcelain



Nickel



Pewter



Limestone



Pebble

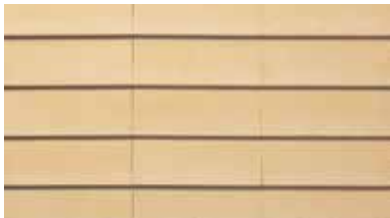

Sandstone

Types

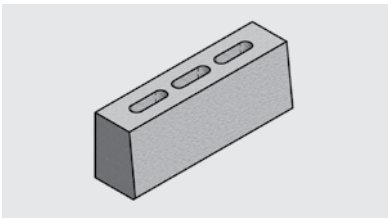

Standard Block

Size: 390L × 100W × 140H mm

Weight: 8.64kg

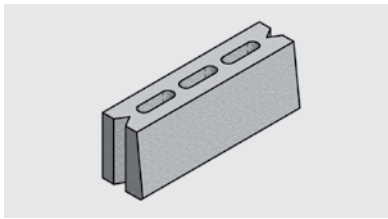

Stretcher Block

Size: 390L × 100W × 140H mm

Weight: 9.11kg

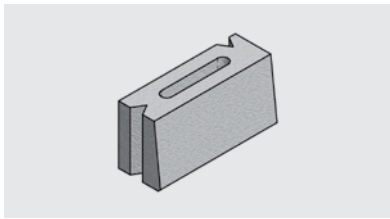

External Corner Left

Size: 280L × 100W × 140H mm

Weight: 6.24kg

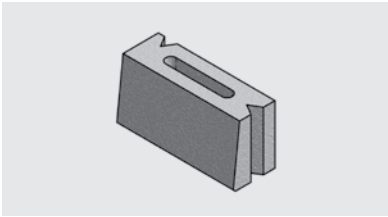

External Corner Right

Size: 280L × 100W × 140H mm

Weight: 6.24kg

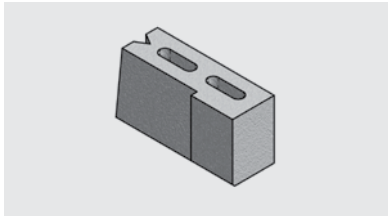

Internal Corner Left

Size: 280L × 100W × 140H mm

Weight: 6.28kg

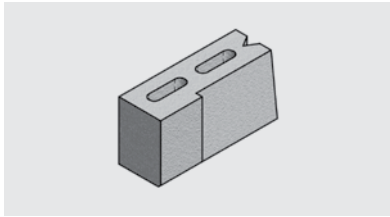

Internal Corner Right

Size: 280L × 100W × 140H mm

Weight: 6.28kg



From left to right: Pewter, Sandstone, Nickel, Limestone, Pebble, Porcelain

Austral Masonry

—

Magnumstone Ledgeface p⁴²

Explorer p⁴⁸

3



Magnumstone Ledgeface



A superior alternative for retaining walls that are brimming with character and bold, rustic texture.

Magnumstone was born out of market demand for a superior looking, fully engineered system that would stand the test of time both visually and structurally.

—

The Magnumstone Ledgeface retaining wall solution boasts the capacity to envelop terrain and curved landscapes with a gentle ease, provide chiselled angles or form corners and curves with unrivalled ability.

No matter the project, Magnumstone's tailor-made system can create a visually striking result while ensuring the highest level of structural integrity. It serves a dual purpose of effective soil retention and an aesthetic softening of the hardscape components of any given project, acting to bring back a natural element to traditionally industrial-looking structures.

Created as a way to eliminate the need for manual handling and large labour costs, Magnumstone's installation process is one of the fastest currently available in market, making it even more advantageous to large scale projects which no longer have to sacrifice style and strength for ease of use.

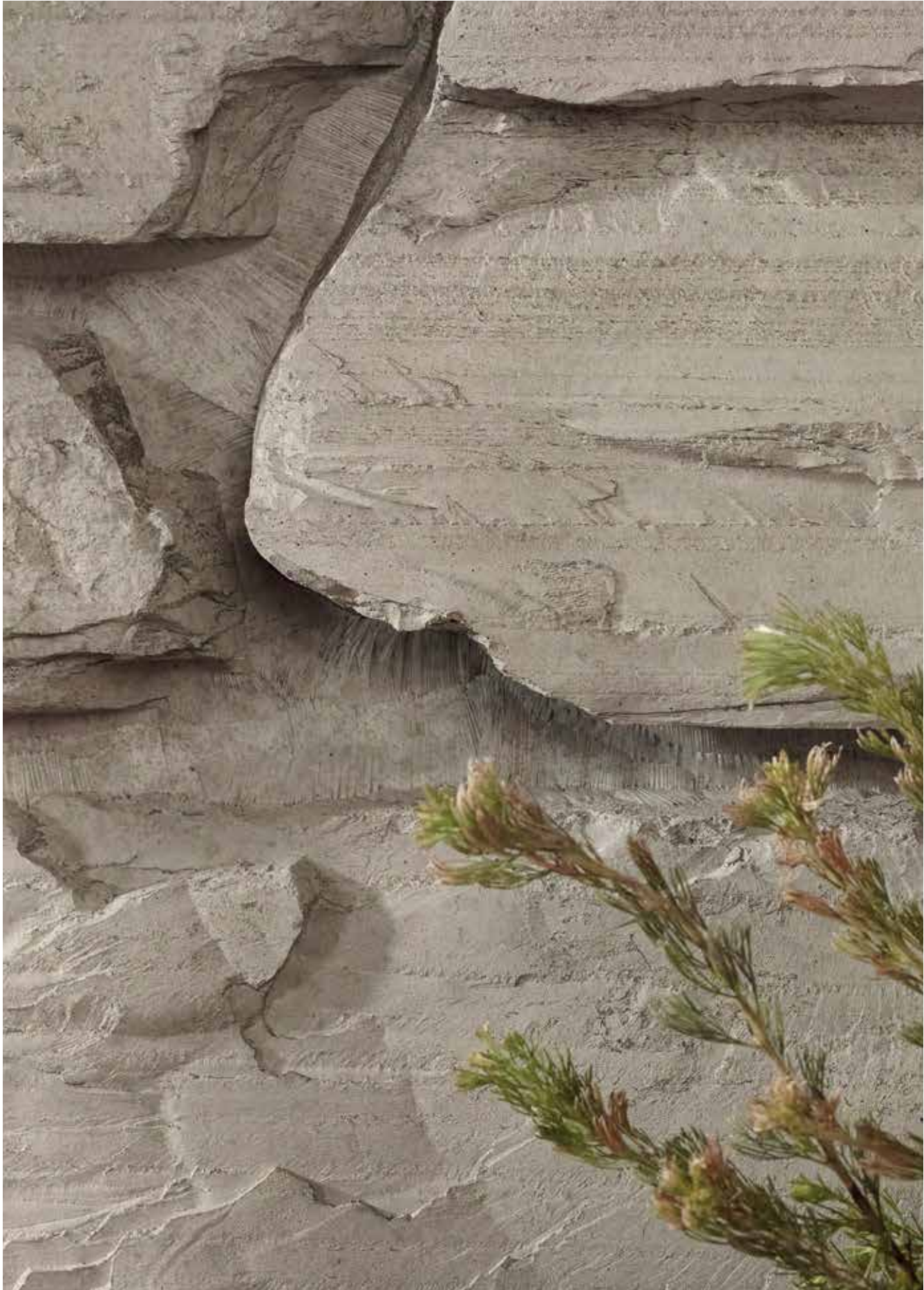

Colours and types

Available in a natural grey hue, the make-up of this unique product is the perfect equilibrium of power and sensitivity, offering an inherent sense of strength with the grace of a natural finish that certainly holds its own against its organic predecessors.

Colours



Ledgeface | Grey



Fieldface | Grey

Types

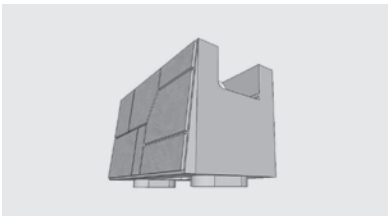

Standard Unit

Size: 1219L x 610W x 610H mm

Weight: 975kg

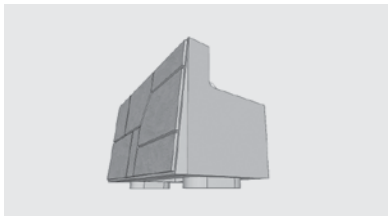

Standard Top Unit

Size: 1219L x 610W x 610H mm

Weight: 907kg

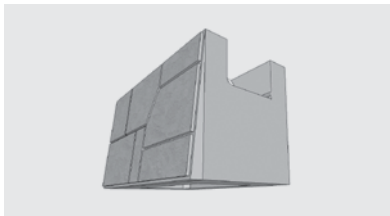

Standard Base Unit

Size: 1219L x 610W x 610H mm

Weight: 956kg

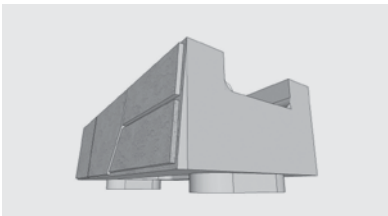

Half High Unit

Size: 1219L x 610W x 305H mm

Weight: 517kg

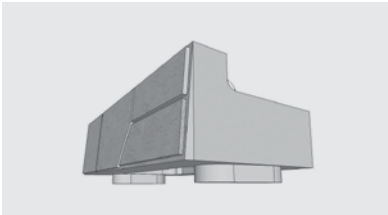

Half High Top Unit

Size: 1219L x 610W x 305H mm

Weight: 489kg

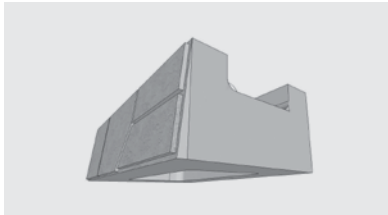

Half High Base Unit

Size: 1219L x 610W x 305H mm

Weight: 328kg



Standard Corner Unit

Size: 711L x 102W x 610H mm

Weight: 154kg



Half Corner Unit

Size: 711L x 102W x 305H mm

Weight: 77kg





Explorer



The smarter way to build concrete retaining walls.

The ideal choice when it comes to aesthetic appeal and superior performance.

—

Both subtle and sleek, Explorer was crafted to blend in to any project whether commercial or residential – a gentle inclusion that would feel at ease among any architectural style. Its smooth long lines and matte finish are satisfyingly simple. Re-imagining the concrete sleeper in a slimmer profile and in panel form with 1000, 600 and 400mm sizes, meant that not only has installation become several times faster, but the ability to control the aesthetic has improved significantly.

No longer does an individual sleeper have to be manipulated to line up exactly with its neighbours, instead, the panelled design takes the stress and time-consuming nature out of the build, reducing scope for mistakes and improving efficiency. The panel format, made up of multiple sleepers, takes up less space and its narrow size also sits straight, meaning that it doesn't intrude on a property's footprint and designers don't lose valuable ground for the sake of including a retaining wall.



Colours and types

All Explorer concrete sleepers include internal reinforcing so they're solid, strong, and dependable. Available in a variety of lengths, and a range of colours and finishes, they're adaptable to almost any project.

Colours



Smooth | Grey



Smooth | Charcoal



Sandstone | Natural



Sandstone | Graphite



Timberlook | Ironbark



Timberlook | Gumtree



Slate | Oak



Slate | Charcoal

Types



Explorer 200

Size: 200H x 75T x 1200L mm

Weight: 40kg



Explorer 200

Size: 200H x 75T x 1530L mm

Weight: 49kg



Explorer 200

Size: 200H x 75T x 2000L mm

Weight: 67kg



Explorer 400*

Size: 400H x 75T x 2000L mm

Weight: 145kg

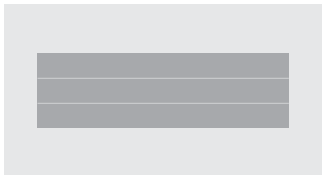

Explorer 600*

Size: 600H x 75T x 2000L mm

Weight: 218kg



Explorer 1000*

Size: 1000H x 75T x 2000L mm

Weight: 362kg



The Details

—

The Benefits

Discover More

Contact

4



The Benefits



When planning to build a sustainable home and a comfortable life, you have a lot to consider. With their complete range of cost, comfort and style benefits, masonry products are the one and only choice.

-
1.

Affordable
For a premium product, our concrete masonry offers an affordable option.
2.

Low maintenance
Minimal maintenance, maximum impact. You're guaranteed a long-lasting, tough, and easy-care solution.
3.

All-weather resistant
Heavy storms. Blistering heat. Sub-zero frosts. Austral Masonry is designed to hold up to anything our weather systems are capable of throwing at it.
4.

Fire resistant
All of our products are non-combustible and highly fire resistant – making them ideal for bushfire prone areas.
-
5.

Termite resistant
With no organic wood materials present in our concrete formulations, our masonry range is naturally termite resistant.
6.

Seamless installation
Easy to install and structurally robust, our masonry works exceptionally well for fast on-site applications.
7.

Environmentally aware
We've designed our production processes to minimise impact on the environment ensuring they do not deplete precious natural resources.
8.

Impact resistance
Our masonry is also renowned for its toughness and hard-wearing properties, and can handle impacts from many external forces.



Discover More

—

Inspiration doesn't always come naturally, so it's worth taking your time to enjoy the creative process. From visiting us at our Design Studios, or exploring our iVisualise Tools online, to chatting in person or over the phone, we're here to help.



Discover

Brickworks Design Studios

Your local Brickworks design studio is a one-stop destination for advice and inspiration, where you can experience the quality of our product range first-hand. Our experienced consultants will guide you through the range and help you find the best possible solution to your project – within your budget.

Call.
1300 Masonry

Create

iVisualise Tools

Using Artificial Intelligence and digital technology, you're now able to experience colours, forms and profiles with our online colour visualisation tool. iVisualise helps make selection seamless and simple – whether you're looking for a more traditional product, or something more contemporary.

Visit.
australmasonry.com.au/ivisualise

Learn

Colour Consultations

Building or renovating a home is a major investment – and it should be an enjoyable experience for you. We can help with a one-to-one colour consultation where our experts can guide you on colour trends, the right fit and style, and ideas that will give you a genuinely individual look.

Book.
australmasonry.com.au

Backed by Brickworks



Local expertise. Global quality. Brickworks Building Products is one of Australia’s biggest building material producers. With heritage going all the way back to one of Australia’s founding brick producers, we’re proud of our reputation for design, innovation and sustainability.



BRICKWORKS

AUSTRALIA



























NORTH AMERICA









EXCLUSIVE DISTRIBUTOR









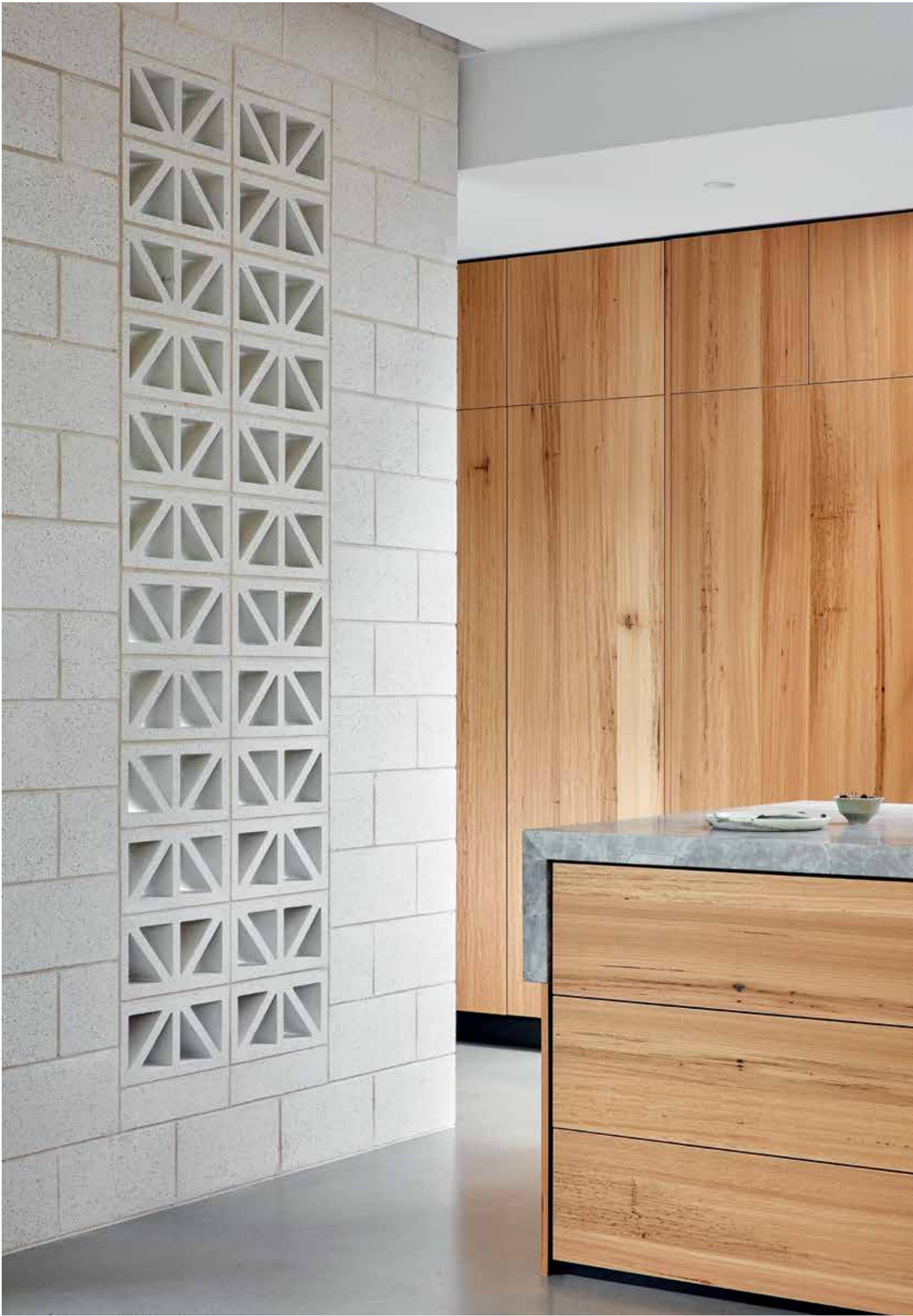

Visit. australmasonry.com.au

Call. 1300 Masonry

Design Studios

Sydney

Tel. 02 9611 4200
2 Barrack Street
Sydney NSW 2000

Adelaide

Tel. 08 8443 2222
70 Hindmarsh Square
Adelaide SA 5000

Melbourne

Tel. 03 8621 7777
367 Collins Street
Melbourne VIC 3000

Perth

Tel. 08 6332 5800
67 King Street
Perth WA 6000

Brisbane

Tel. 07 3634 5604
27 James Street
Fortitude Valley QLD 4006

Hobart

Tel. 03 6212 9120
210 Elizabeth Street
Hobart TAS 7000

Follow us



The product images in our brochures give a general indication of colour for your preliminary selection.
We also recommend you view current product samples before making your final selections.

Visit. australmasonry.com.au
Call. 1300 Masonry

BRICKWORKS