

Thin Brick

Residential Collection



What's inside

1 – Thin Brick Collection p⁹

2 – Installation Guide p¹⁹

A BRAND OF

BRICKWORKS

Real, authentic bricks –
perfectly cut down to easy-
to-install facings. The perfect
answer for fast renovations
and impressive features.



Transform any space with the beauty of brick

A new and easier way

Enhance your home in a weekend with the lightweight and easy to install Thin Brick. Our new range of slimline brick facings allow you to bring the effortless and authentic style of bricks to almost any space.

The Thin Brick advantage:

1.

Design flexibility

Our versatile slim brick format helps you realise your creative vision and transform any space inside or out.

2.

Broad choice

Choose from an extensive range of colours and textures to match your style and design.

3.

Time-saving

Assemble in no time with simple adhesive fixing.



More impact with less effort

Thinner profile. Better results.

Because Thin Brick is genuine brick only thinner, it gives you more flexibility to add style and authenticity to any part of your home, reducing the cost and time that it would take for standard brick applications.

Where to use Thin Brick

There's no limit to Thin Brick's range of applications inside or outside your home. Striking splashbacks, statement walls and arches, cosy fireplaces, regal wine cellars, inviting outdoor entertaining areas, exquisite floors and more, are all possible with Thin Brick.

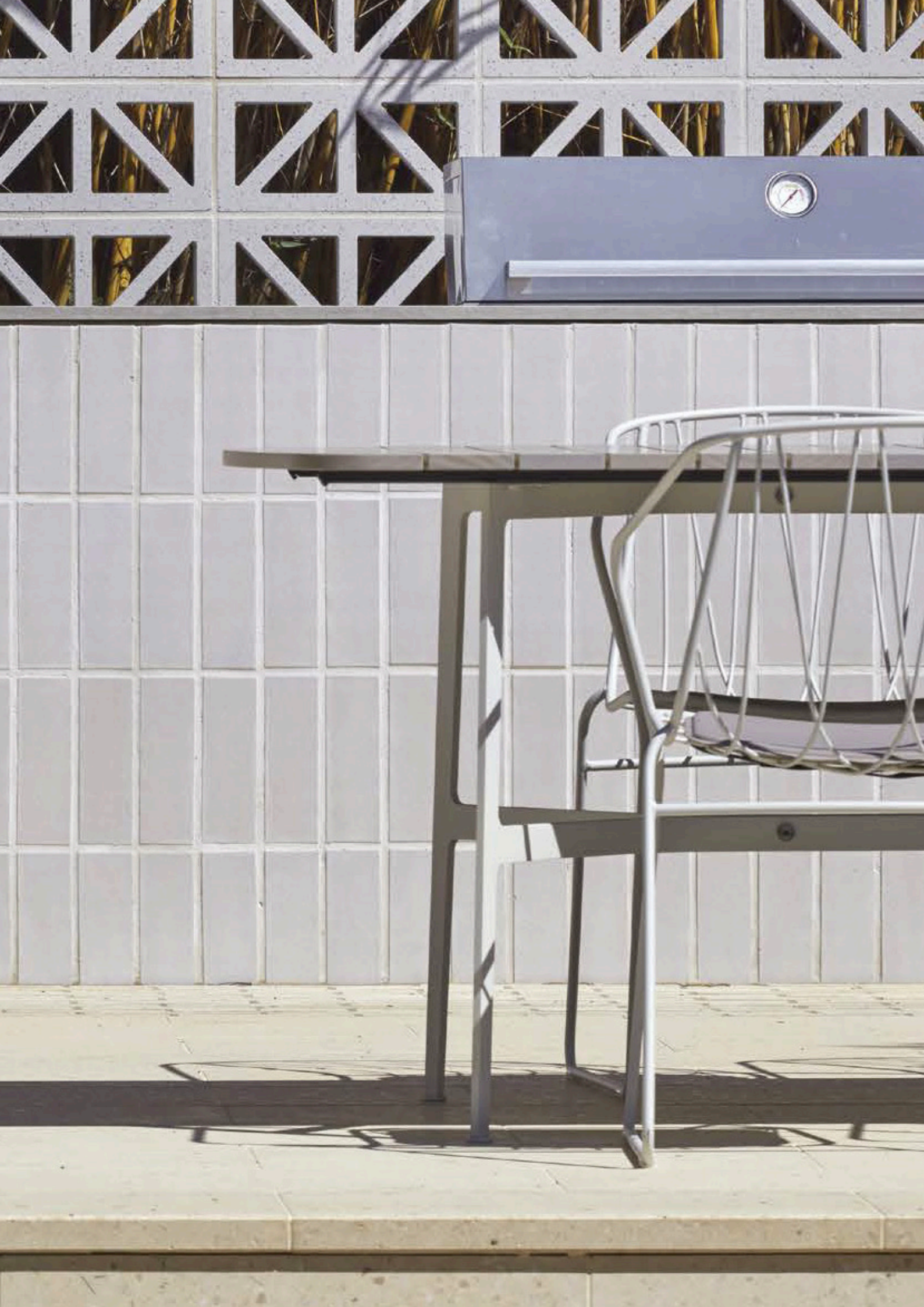

3-step installation guide



1. Prepare

The brick facing and substrate must be clean & free from form oil, curing compounds, laitance, dirt or any other surface contaminants. Extra care should be taken to ensure the substrate is fully dry, cured and any foreign material such as oil, release agents or dirt should be removed prior to installation.

For porous surfaces, primer should be applied as per the adhesive manufacturer's instruction and ensure to allow sufficient time between priming and installation.



2. Apply

Apply adhesive and stone cladding working from the bottom up, or from the top down. Working from the top down may help avoid splashing previously applied Thin Brick with dripping mortar.

Adhesive shall be applied with a notched trowel using a scraping motion to work the material into good contact with the surface to be covered.

Only as much adhesive shall be applied as can be covered within 5 to 10 minutes or while mortar surface is still wet and tacky. For small areas, a pre-mixed adhesive may be used.



3. Mortar

For mortar joints, an additive should be added to thicken the mortar mix when a pointing/grouting/hopper gun is used to fill the joints.

Alternatively, pre bagged grouts, suitable for wide joints, can be used and trowelled into the joints. Never sponge the mortar over the surface of the brickwork, this will be hard to remove and will cause staining.

Care must be taken to avoid smearing mortar on surface of the Thin Brick. Accidental smears or mortar droppings should be removed using a whisk broom or stiff bristled nylon brush only after mortar has become crumbly. A wet brush or sponge should never be used.



Install Checklist

The essential items you'll need

Here's our list of essential items you'll need to get going with Thin Brick:

- 20L pail
- 8mm notch tile trowel
- Mortar shaping dowel
- Disposable mortar piping bag
- Brick brush
- 10mm Tile spacers
- Adhesive
- Pointing/grouting/hopper gun
- Sponge

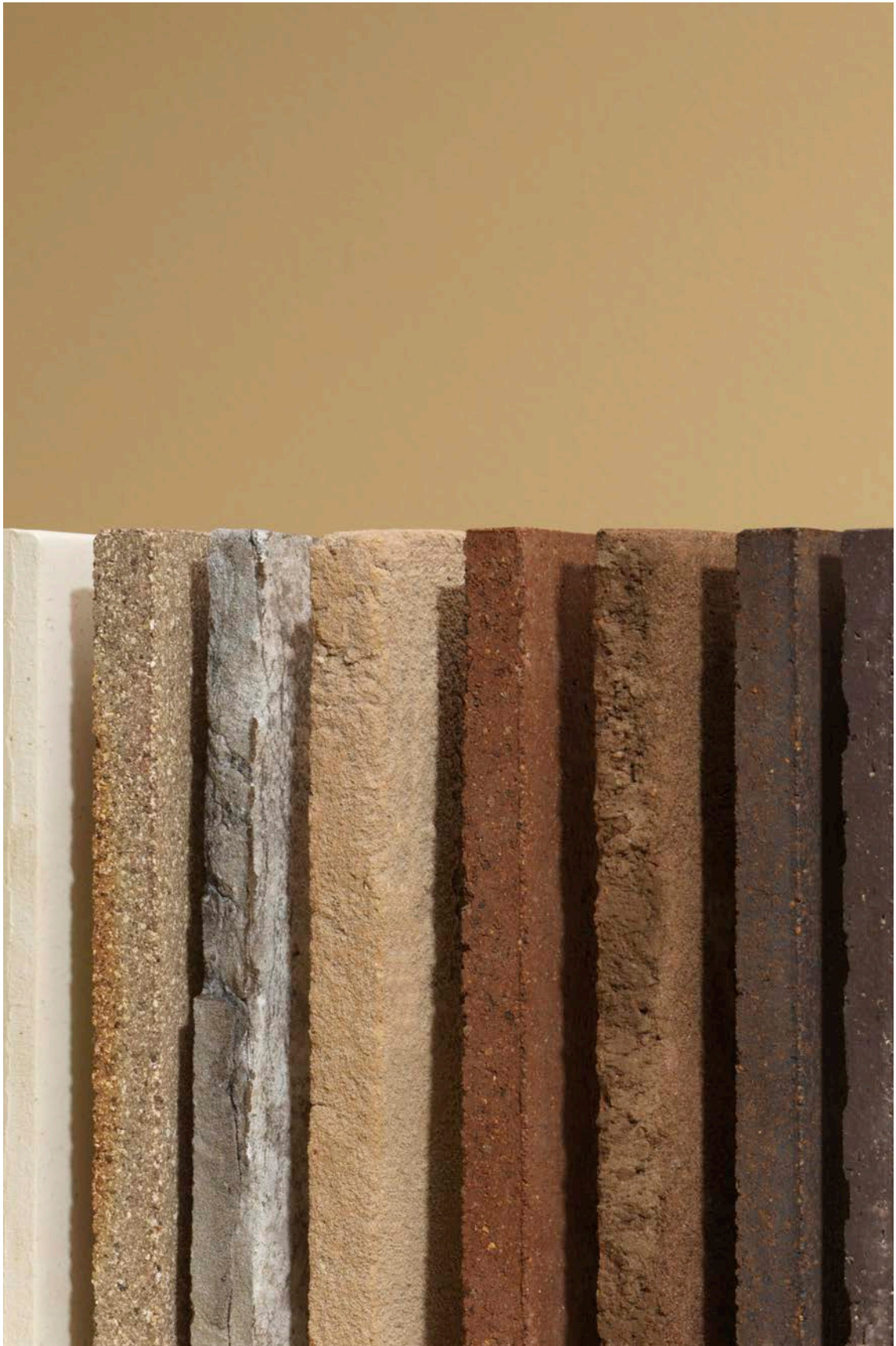

Thin Brick Collection

- La Paloma
- San Selmo Reclaimed
- San Selmo Smoked



La Paloma

Spain – confident, creative and the artistry of Dali, Picasso, Miró, which give inspiration to the soft white and charcoal black bricks of La Paloma and La Paloma Rustico. Characterful, eye-catching and steeped in heritage, they express two striking colours found in the spectrum of fired clay colours, transforming buildings into works of art.

Colours



Castellana



Miro



Azul



Romero



San Selmo Reclaimed

Inspired, rustic and charming. The unique San Selmo range of Reclaimed embodies the beauty of brick. The San Selmo range suits all contemporary projects and environments.

Colours



Reclaimed Original



Limewash



Aged Red



San Selmo Smoked

The San Selmo range of Smoked bricks encapsulate the inherent beauty of brick. With hues that transition from light to dark and subtle tactile finishes, the San Selmo range suits a vast range of project styles.

Colours



Cloudy Silver



Grey Cashmere



Opaque Slate



Wild Storm



Thin Brick Collection Overview

—

Highly suited for internal applications and hard to access areas, the Thin Brick range is an intelligent and cost-effective solution that delivers both functionality and beauty.

La Paloma

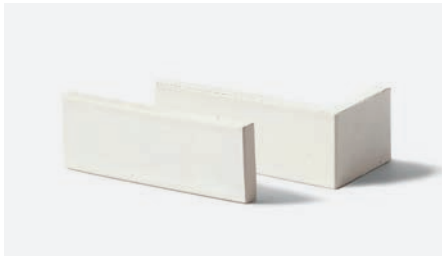

Castellana



Miro



Azul



Romero



Glazed White



Glazed Black

San Selmo Reclaimed



Limewash



Reclaimed Original



Aged Red

San Selmo Smoked



Grey Cashmere



Cloudy Silver



Opaque Slate



Wild Storm

Types



Standard Face

Size: 230 x 76 x 18mm



Corner Tile

Size: 230 x 110 x 76 x 18mm



Installation Guide

2

Easy installation options

One of the many beauties of Thin Brick is the variety methods available when it comes to installation – ones that do not require a skilled labourer.



Preparation

To ensure an everlasting and striking appearance of your brick facings the following best practices should be adopted. The brick facings and substrate should be clean and free from any loose particles and surface contaminants. Extra care should be taken to ensure the substrate is fully dry, cured and any foreign material such as oil, release agents or dirt, should be removed prior to installation. For porous surfaces such as fibre cement, priming may also be necessary.

Adhesive fixing the facings to the substrate is recommended by Brickworks for installations up to 3.5m. For applications over 3.5m the use of support angles or mechanical fixing is recommended.

There are many adhesives available and the most suitable is dependent on the specific requirements of each project. Variables to consider include the height, service conditions, substrate type and installation technique.

The following products are available from major tile retailers or large hardware stores. Always ensure to consult with the adhesive manufacturer and check the suitability of the adhesive for the substrate and service conditions.

Adhesives for Brick Facing Applications

Dry Internal Areas

- Ardex X17
- Dunlop Universal Tile Adhesive
- Davco SMP Evo
- Dunlop Premixed Mastic Tile Adhesive

Dry External Areas

- Ardex X77
- Dunlop Universal Tile Adhesive
- Davco SMP Evo
- Bostik Ultramastik

Wet External Areas / Wet Internal Areas / Fibre Cement Boards

- Davco SMP Evo + Davelastic
- Ardex X77 + E90 Additive
- Dunlop Universal Tile Adhesive + Primer & Additive
- Bostik Ultramastik + Megalastic
- Bostik Evoflex

Limitations

- Adhesive fixing can only be used for applications up to 3.5m in height, from ground level, internally or externally.
- Mechanical fixing must be used where brick facings exceed 3.5m in height.
- Ardex Australia Pty Ltd adhesives are limited to installations up to 3m in height.
- Adhesive fixing is not recommended for brick facings onto Blueboard and plasterboard.
- Precast concrete panels may contain release agents or a densified paste layer. The adhesive manufacturer should be consulted for preparation guidance and may require a suitable primer system.
- Fibre cement sheets should be primed as per the adhesive manufacturer's instructions and ensure to allow sufficient time between priming and installation.

Mortar Joints

For mortar joints, an additive should be added to thicken the mortar mix and a pointing/grouting/hopper gun (such as the one shown below) should be used to fill the joints. For the mortar to flow through a pointing gun an additive is required. Suitable additives include Metcell, a water thickener, or a plasticiser to assist with workability and flow. Alternatively, pre bagged grouts suitable for wide joint grouts can be used and trowelled into the joints.

Care needs to be taken to ensure that the grout doesn't get onto the brick facings as this will result in staining.



Typical Installation Details

Masonry wall example

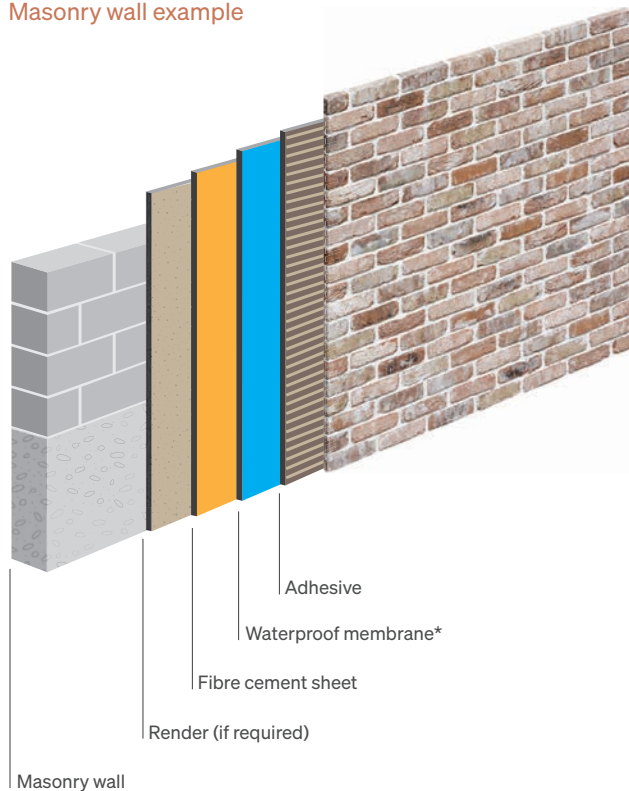

Stud wall example

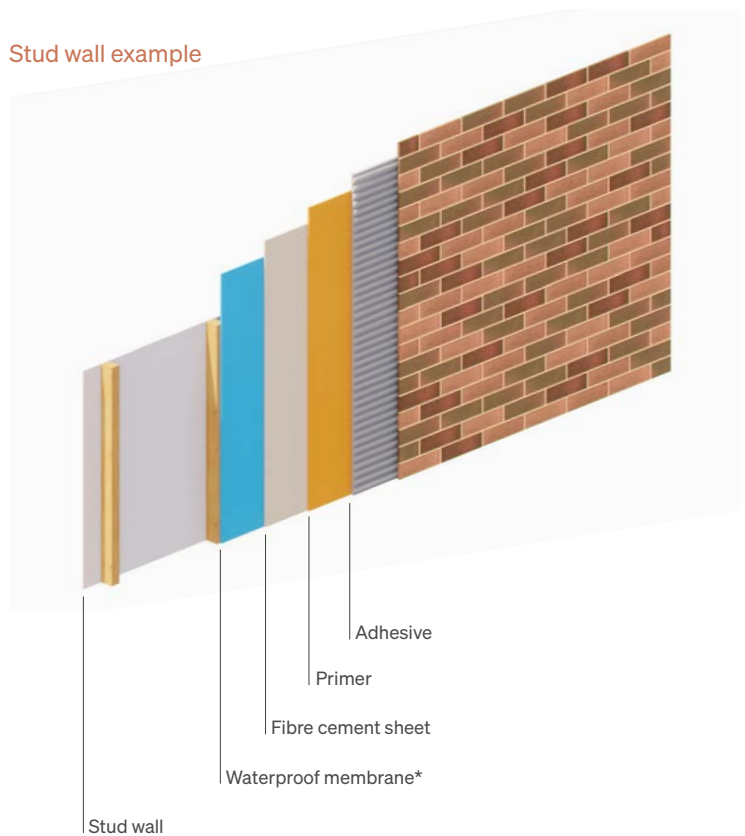

Dimensions

Facing Unit

230L x 76H x 18mm Thick

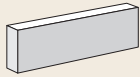

Corner Unit

230L x 76H x 110W x 18mm Thick

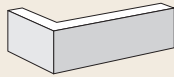

Laying Patterns

A bond refers to the pattern in which bricks are laid.
The most common bond used is Stretcher Bond.

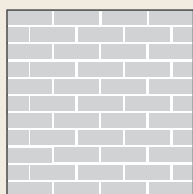

Stretcher Bond

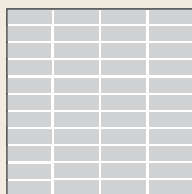

Stack Bond

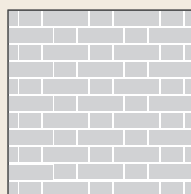

Flemish Bond

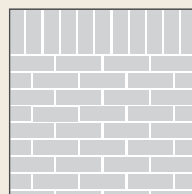

Soldier Course with
Flemish Bond

Common Mortar Joints



Shallow Ironed
(Rolled)

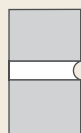

Deep Ironed
(Rolled)

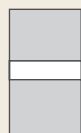

Struck Flush



Weather Struck

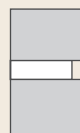

Raked

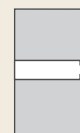

Beaded Pointing

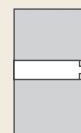

Tuck Pointing

Common Mortar Joints

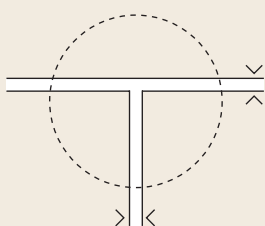

Mortar 10mm

Mortar 10mm

General Information

Expansion, Movement and Control Joints

Existing expansion/control joints in substrate must be carried through the Thin Brick and shall conform to architectural details. Refer to Australian Standards AS3958.1 & 2 for more details.

Refer to architects & engineer's drawings for full details on expansion, control, isolation or movement joints. (Do not lay veneer stone, screed or render over construction joints).

Efflorescence

Efflorescence is a water-soluble salt that is deposited on the surface of masonry products by the evaporation of water from the wall. On rare occasions efflorescence will occur on Thin Brick® cladding. Efflorescence will fall away naturally over time but can be removed more quickly using a stiff nylon bristle brush when the Thin Brick and mortar are completely dry. Do not attempt to wash or spray the efflorescence. This merely dissolves the salt and allows it to enter the stone only to re-emerge later.

Sealers

Sealers are not necessary on Thin Brick cladding. However, some customers use sealers to help prevent staining in applications prone to graffiti, smoke, soot and dirt. If you choose to use a sealer, make sure it is a breathable sealer. Take note that some sealers may darken the colour of the face of the bricks. For information regarding actual performance or application of sealers, contact the manufacturer of the sealer directly.



Discover More

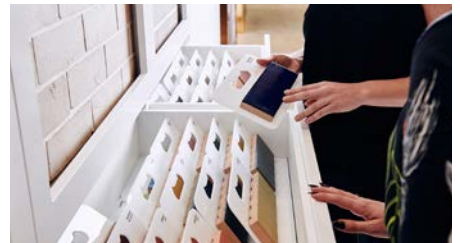

Discover

Brickworks Design Studios

Your local Brickworks design studio is a one-stop destination for advice and inspiration, and where you can experience the quality of our product range first-hand. Our experienced consultants will guide you through the range and help you find the best possible solution for your project – within your budget.

Call.
13 Brick

Create

iVisualise Tools

Using Artificial Intelligence and digital technology, you're now able to experience colours, forms and profiles with our online colour visualisation tool. iVisualise helps make selection seamless and simple – whether you're looking for a more traditional product, or something more contemporary.

Visit.
australbricks.com.au/ivisualise

Learn

Colour Consultations

Building or renovating a home is a major investment – and it should be an enjoyable experience for you. We can help with a one-to-one colour consultation where our experts can guide you on colour trends, the right fit and style, and ideas that will give you a genuinely individual look.

Book.
australbricks.com.au/colour



Backed by Brickworks

Local expertise. Global quality. Brickworks is one of Australia’s biggest building material manufacturers. With heritage going all the way back to one of Australia’s founding brick producers, we’re proud of our reputation for design, innovation and sustainability.

BRICKWORKS

AUSTRALIA

NORTH AMERICA

EXCLUSIVE DISTRIBUTOR



Get in touch

—

For more information, advice
and samples get in touch
with the Austral Bricks team.



Visit. australbricks.com.au

Call. 13 Brick

Design Studio

Sydney

Tel. 02 9611 4200
2 Barrack Street
Sydney NSW 2000

Design Centres

Albion Park

Tel. 02 4257 1566
45 Princes Highway
Albion Park NSW 2527

Canberra

Tel. 02 6143 2400
7 Lithgow Street
Fyshwick ACT 2609

Beresfield

Tel. 02 4944 6200
2 Yangan Drive
Beresfield NSW 2322

Coffs Harbour

Tel. 02 6652 3457
27 Lawson Street
Coffs Harbour NSW 2450

Bowral

Tel. 02 4861 3031
Lot 1 Oxleys Hill Road
Bowral NSW 2576

Punchbowl

Tel. 02 9915 9100
Christian Road
North Punchbowl NSW 2196

Head Office

Horsley Park

Tel. 02 9830 7777
Oakdale East Industrial Estate
2 Latitude Road
Horsley Park NSW 2175

Follow Us



Visit. australbricks.com.au

Call. 13 Brick

A BRAND OF

BRICKWORKS

